

# KitchenAid

## PROFESSIONAL BLENDER

5KSBC1B0

PRODUCT GUIDE



---

W11499112A

# PARTS AND FEATURES

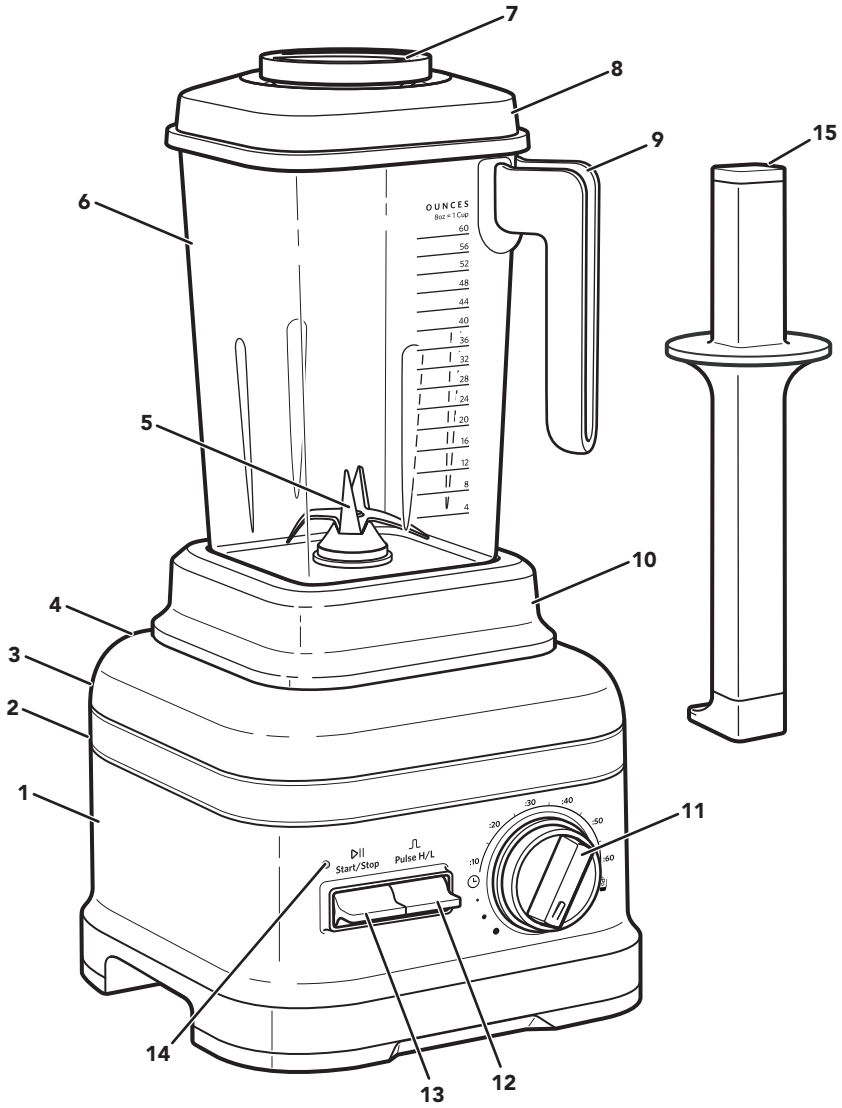

- |                                      |                               |
|--------------------------------------|-------------------------------|
| 1. Base                              | 8. Lid                        |
| 2. Cord Cleat (not shown)            | 9. Jar Handle                 |
| 3. Power Switch (not shown)          | 10. Removable Blender Jar Pad |
| 4. Detachable Power Cord (not shown) | 11. Control Dial              |
| 5. Blade                             | 12. Pulse Toggle Switch       |
| 6. Blender Jar                       | 13. Start/Stop Toggle Switch  |
| 7. Ingredient-Measuring Cap          | 14. Status Indicator Light    |
|                                      | 15. Flex Edge Tamper          |

# PRODUCT SAFETY

## Your safety and the safety of others are very important.

We have provided many important safety messages in this manual and on your appliance. Always read and obey all safety messages.



This is the safety alert symbol.

This symbol alerts you to potential hazards that can kill or hurt you and others.

All safety messages will follow the safety alert symbol and either the word "DANGER" or "WARNING." These words mean:

**⚠ DANGER**

**You can be killed or seriously injured if you don't immediately follow instructions.**

**⚠ WARNING**

**You can be killed or seriously injured if you don't follow instructions.**

All safety messages will tell you what the potential hazard is, tell you how to reduce the chance of injury, and tell you what can happen if the instructions are not followed.

## IMPORTANT SAFEGUARDS

**When using electrical appliances, basic safety precautions should always be followed, including the following:**

1. Read all instructions. Misuse of appliance may result in personal injury.
2. To protect against risk of electrical shock, do not put Blender in water or other liquid.
3. This appliance is not intended for use by persons (including children) with reduced physical, sensory or mental capabilities, or lack of experience and knowledge, unless they have been given supervision or instruction concerning use of the appliance by a person responsible for their safety.
4. European Union Only: This appliance shall not be used by children. Keep the appliance and its Cord out of reach of children.

- 5.** European Union Only: Appliances can be used by persons with reduced physical, sensory or mental capabilities or lack of experience and knowledge if they have been given supervision or instruction concerning use of the appliance in a safe way and understand the hazards involved.
- 6.** Children should be supervised to ensure they do not play with the appliance.
- 7.** Avoid contacting moving parts. Keep hands, hair, clothing, as well as spatulas and other utensils away from Blade during operation to reduce the risk of injury to persons and/or damage to the Blender.
- 8.** Turn the appliance off (O), then unplug from the outlet when not in use, before assembling or disassembling parts and before cleaning. To unplug, grasp the plug and pull from the outlet. Never pull from the Power Cord.
- 9.** Do not operate any appliance with a damaged cord or plug, or after the appliance malfunctions, or is dropped or damaged in any manner. Return appliance to the nearest Authorised Service Facility for examination, repair, or electrical or mechanical adjustment.
- 10.** If the Supply Cord is damaged, it must be replaced by KitchenAid, its service agent or similarly qualified persons in order to avoid a hazard.
- 11.** Do not let Cord hang over edge of table or counter.
- 12.** Do not let the Cord contact hot surfaces, including the stove.
- 13.** Blades are sharp. Care should be taken when handling the sharp cutting Blades, emptying the jar, and during cleaning.
- 14.** Flashing light indicates ready to operate - avoid any contact with Blades or moveable parts.
- 15.** When blending hot liquids or ingredients, Ingredient-Measuring Cap should remain in place over the Lid opening. Always start on lowest speed and slowly ramp to desired speed when blending hot liquids or ingredients.
- 16.** Keep hands and utensils out of jar while blending to reduce the risk of severe injury to persons or damage to the Blender. A scraper may be used but must be used only when the Blender is not running.
- 17.** Do not use the appliance outdoors.
- 18.** Never leave the appliance unattended while it is in operation.

19. Be careful if hot liquid is poured into the Blender as it can be ejected out of the appliance due to sudden steaming.
20. Always operate appliance with Lid in place.
21. The use of accessories/attachments not recommended or sold by KitchenAid may cause fire, electric shock, or injury to persons.
22. Allow the appliance to cool completely before putting on or taking off parts, and before cleaning the appliance.
23. Refer to the “Care and Cleaning” section for instructions on cleaning the surfaces in contact with food.
24. This appliance is intended to be used in household and similar applications such as:
  - staff kitchen areas in shops, offices and other working environments;
  - farmhouses;
  - by clients in hotels, motels and other residential type environments;
  - bed and breakfast type environments.

## SAVE THESE INSTRUCTIONS

For complete details on product information, instructions and videos, including Guarantee information, visit [www.kitchenaid.co.uk/product-tips](http://www.kitchenaid.co.uk/product-tips), [www.kitchenaid.ie/product-tips](http://www.kitchenaid.ie/product-tips), or [www.KitchenAid.eu](http://www.KitchenAid.eu).

### ELECTRICAL REQUIREMENTS

#### **! WARNING**

##### Electrical Shock Hazard



**Plug into an earthed outlet.**

**Do not remove earth prong.**

**Do not use an adapter.**

**Do not use an extension cord.**

**Failure to follow these instructions can result in death, fire, or electrical shock.**

**Voltage:** 220-240 V

**Frequency:** 50-60 Hz



**Power:** 1800 W

**NOTE:** If the plug does not fit in the outlet, contact a qualified electrician. Do not modify the plug in any way. Do not use an adapter.

Do not use an extension cord. If the Power Cord is too short, have a qualified electrician or service technician install an outlet near the appliance.

## BLENDER FUNCTION GUIDE

The Blender has a preset recipe programme: Icy Drinks. It also features Variable Times and Pulse functions that allow you to customize your blending for any recipe you make.

SETTING	DESCRIPTION	BLENDING TIME (in min:sec)
	Gradually ramp up to full power to completely blend hard foods such as ice, whole fruits or vegetables, or frozen fruits. This cycle is recommended for such drinks as margaritas, daiquiris, and blended ice coffee drinks.	0:22
•	When Low speed is selected, the Blender will run continuously on low until the ▷   (Start/Stop) Toggle Switch is pressed, or after 6 minutes elapse.	N/A
•	When Medium speed is selected, the Blender will run continuously on medium until the ▷   (Start/Stop) Toggle Switch is pressed, or until 6 minutes elapse.	N/A
•	When High speed is selected the Blender will run continuously on high until the ▷   (Start/Stop) Toggle Switch is pressed, or after 6 minutes elapse.	N/A
 Pulse H/L	Alternatively, use Pulse during manual operation to manually operate the Blender at either High or Low speeds.	N/A
<b>VARIABLE TIMES</b>	The timer function starts at a slow speed and ramps up to a high speed for optimal blending results.	0:05-0:60

To clean the Blender: Quick pulses of power and high speeds work to clean the Blender Jar with just 2 cups of water and a drop of dish soap.

# PRODUCT ASSEMBLY

## PREPARING THE BLENDER FOR USE

### **⚠ WARNING**

#### **Electrical Shock Hazard**



**Plug into an earthed outlet.**

**Do not remove earth prong.**

**Do not use an adapter.**

**Do not use an extension cord.**

**Failure to follow these instructions can result in death, fire, or electrical shock.**

#### **Before first use**

Before using your Blender for the first time, wipe the Blender Base with a warm, damp cloth, then wipe clean with a damp cloth. Dry with a soft cloth. Wash the Blender Jar, Lid, Flex Edge Tamper, and Ingredient-Measuring Cap in warm, sudsy water (see the "Care and Cleaning" section). Rinse parts and wipe dry.

1. Before using the Blender, be sure the countertop beneath the Blender and surrounding areas are dry and clean. Then, plug the Blender into an earthed outlet.

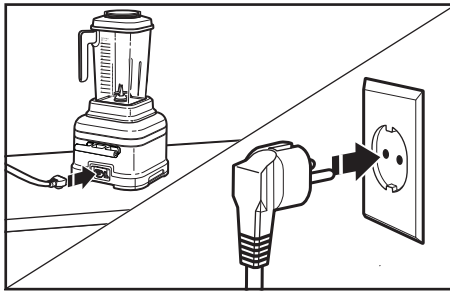

2. The main Power Switch is on the back of the Blender Base. Flip the Power Switch to ON (I). The Status Indicator Light above the  (Start/ Stop) Toggle Switch will begin to flash, indicating that the Blender is in Standby Mode. The Blender is now ready to operate.

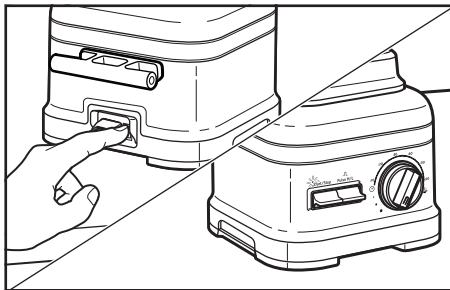

# PRODUCT USAGE

1. Put the items to blend into the Blender Jar. Add liquids first, then soft foods, then leafy greens, and ice or frozen items last.

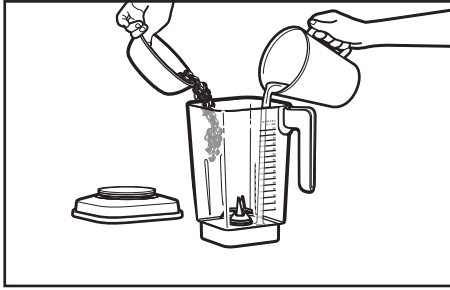

**NOTE:** Do not fill Blender Jar past the topmost measurement mark, especially when blending liquids.

2. Make sure that the Lid is fully secured on the Blender Jar. Next, place the Blender Jar on the Base, making sure that it is fully aligned on the Jar Pad.

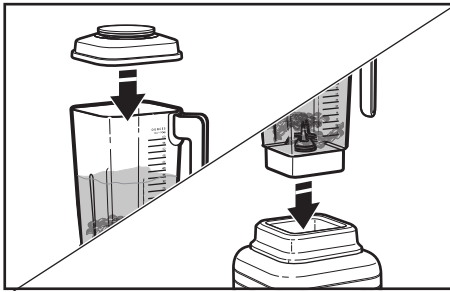

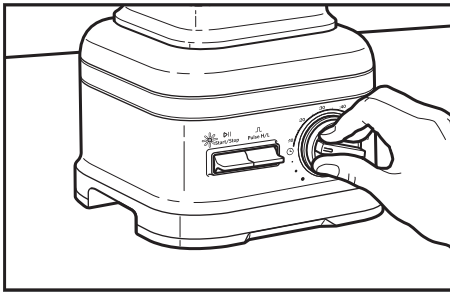

3. Turn the Control Dial to your desired speed, time, or programme. See the “Blender Function Guide” for more information.



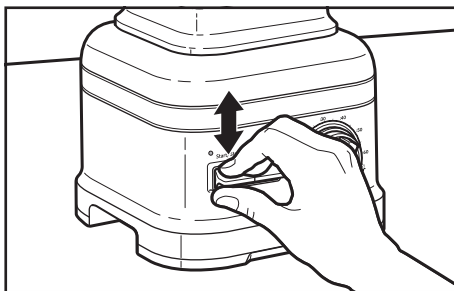

4. Flip the  (Start/Stop) Toggle Switch up or down to begin operation of the Blender. The Status Indicator Light will now be solid.



**NOTE:** If you select a pre-programmed cycle, you will need to flip the  (Start/Stop) Toggle Switch to begin operation. The Blender will automatically stop running once the cycle is complete.

5. Utilize the Flex Edge Tamper accessory as needed for optimal blending performance. Remove the Ingredient-Measuring Cap only, and leave the Lid in place. Stir or press contents down towards the Blade. When you are finished, replace the Ingredient-Measuring Cap to the Blender Jar.



6. If desired, use the Pulse function for a momentary boost of speed while blending on the variable speed settings.

Press and Hold the  (Pulse) Toggle Switch up for a faster pulse, or down for a slower pulse.

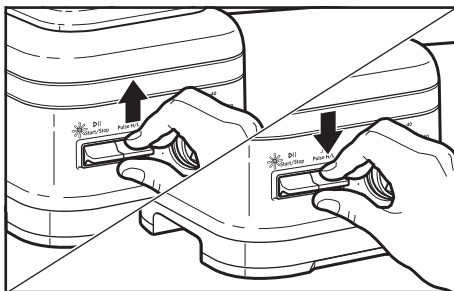

**NOTE:** The Pulse function may also be used on its own as a separate blending function while the Blender is in Standby Mode. Pulse is not available when running a preset program.

- After blending, flip the  (Start/Stop) Toggle Switch up or down. Allow the Blender to come to a complete stop before removing the Lid and pouring your blended ingredients.

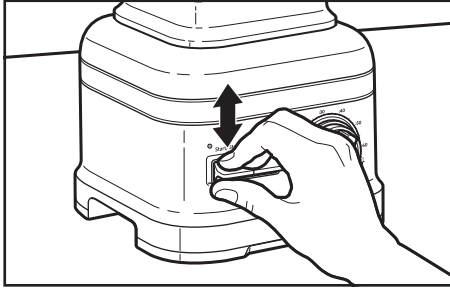

## CARE AND CLEANING

### CLEANING THE BLENDER AND ACCESSORIES

Clean the Blender thoroughly after every use.

**NOTE:** Allow the appliance to cool completely before putting on or taking off parts, and before cleaning the appliance. To avoid damaging the Blender, do not immerse the Blender Base or Cord in water. To avoid scratching the Blender, do not use abrasive cleansers or scouring pads.

- To clean the Blender Base and Cord: Unplug the Blender before cleaning. Wipe the Base and the Cord with a warm, damp, soapy cloth; wipe clean with a damp cloth, and dry with a soft cloth.

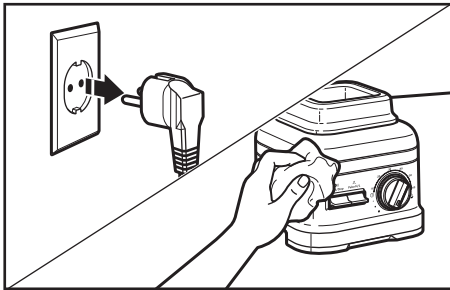

- Make sure to clean the Blender Jar, Lid, and Ingredient-Measuring Cap after each use. Remove any remaining contents from the Blender Jar. Fill 1/3 of the Blender Jar with warm water and add 1 drop of liquid detergent. Place the Lid on the Blender Jar, and make sure the Blender Jar is fully in place on the Blender Base.

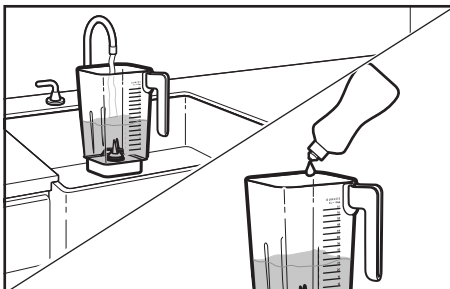

3. Rotate the Control Dial to 30 seconds. Flip the  (Start/Stop) Toggle Switch up or down. When the timer finishes, pour out the soapy water and rinse the Blender Jar with warm water.

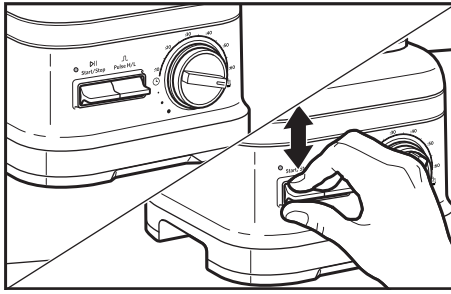

4. The Blender Jar, Lid, Flex Edge Tamper, and Ingredient-Measuring Cap are dishwasher-safe; the Flex Edge Tamper, Lid, and Ingredient-Measuring Cap should be placed in the top rack of the dishwasher. If preferred, all parts may also be washed by hand with a damp cloth and warm soapy water, and then rinsed with warm water and dried with a soft cloth.

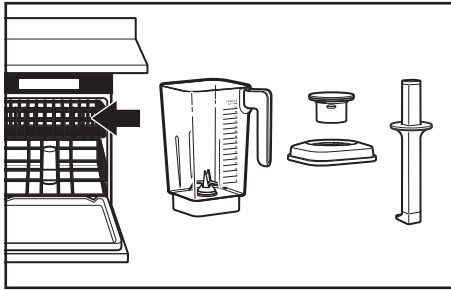

# TROUBLESHOOTING

## **⚠️ WARNING**



### Electrical Shock Hazard

**Plug into an earthed outlet.**

**Do not remove earth prong.**

**Do not use an adapter.**

**Do not use an extension cord.**

**Failure to follow these instructions can result in death, fire, or electrical shock.**

PROBLEM	SOLUTION
<p>When the Blender is plugged in and the <b>I/O</b> (main power ON/OFF) Toggle Switch is ON (<b>I</b>), the Blender will go into Standby Mode (flashing white Indicator Light). However, after 10 minutes of no activity the Blender will go into Sleep mode and the Indicator Light will turn off.</p>	<p>To wake up the Blender, simply flip the <b>▷  </b> Start/Stop Toggle Switch up or down. This will put the Blender back into Standby Mode.</p>
<p>If the Status Indicator Light flashes an orange colour, the Blender is in error mode. This can be caused by using a spatula in the Blender Jar that locks up the Blade or having an ice cube or hard food in a location that locks up the Blade.</p>	<p>Correct the problem by turning off (<b>O</b>) the Blender using the dedicated off switch in the back, or by unplugging the Blender. Remove the Blender Jar from the Base, and clear the items. Place the Blender Jar back on the Base, and then turn the Blender back on to continue regular use.</p>
<p>If the Blender stops while blending.</p>	<p>After 6 minutes of run time, the Blender will automatically shut off and go into Sleep mode, and the LED light will turn off. You can wake the Blender back up using the Toggle Switches <b>▷  </b> (Start/Stop or Pulse High/Pulse Low). If the Blender stops in less than 6 minutes, it is possible there is an internal error with the Blender.</p>
<p>If the ingredients of a recipe aren't blending.</p>	<p>There may be times when an air pocket is created around the Blade, causing the ingredients to miss the blending Blade. Use your Flex Edge Tamper to assist during the blend by pushing ingredients into the Blade, or stir to move ingredients around the Blender Jar. If that does not work, stop the Blender, remove the Blender Jar from the Base, and use a spatula to rearrange ingredients in the Blender Jar. For certain recipes, try adding more liquid.</p>
<p>If you experience an overflow from the Blender Jar.</p>	<p>Unplug the Blender. Remove the Jar and Jar Pad. Clean the Blender housing, Jar Pad, and exterior of the Jar. Dry each part thoroughly, and then reinstall the Jar Pad.</p>

PROBLEM	SOLUTION
If you experience an overflow from the Blender Jar.	If the overflow is on or over the Control Dial, it can be removed by gently and firmly pulling it off. After cleaning and drying, reinstall the knob. To avoid damage to the graphics, do not apply too much force or use abrasive cleansers.
If the problem cannot be corrected.	See the "Terms of KitchenAid Guarantee ("Guarantee")" sections. Do not return the Blender to the retailer; retailers do not provide service.

## ELECTRICAL EQUIPMENT WASTE DISPOSAL

### DISPOSAL OF PACKING MATERIAL

The packing material is recyclable and is marked with the recycle symbol ♻. The various parts of the packing must therefore be disposed of responsibly and in full compliance with local authority regulations governing waste disposal.

### RECYCLING THE PRODUCT

- This appliance is marked in compliance with law in the EU and UK covering, Waste Electrical and Electronic Equipment (WEEE).
- By ensuring this product is disposed of correctly, you will help prevent potential negative consequences for the environment and human health, which could otherwise be caused by inappropriate waste handling of this product.
- The symbol ♻ on the product or on the accompanying documentation indicates that it should not be treated as domestic waste but must be taken to an appropriate collection centre for the recycling of electrical and electronic equipment.

For more detailed information about treatment, recovery and recycling of this product, please contact your local city office, your household waste disposal service or the shop where you purchased the product.

## DECLARATION OF CONFORMITY

### FOR UNITED KINGDOM

This appliance has been designed, constructed and distributed in compliance with the safety requirements of UK Legislation: Electrical Equipment (Safety) Regulations 2016, Electromagnetic Compatibility Regulations 2016. The Ecodesign for Energy-Related Products and Energy Information (Amendment) (EU Exit) Regulations 2019. The Restriction of the Use of Certain Hazardous Substances in Electrical and Electronic Equipment Regulations 2012.

### FOR EUROPEAN UNION

This appliance has been designed, constructed, and distributed in compliance with the safety requirements of EC Directives: Low Voltage Directive 2014/35/EU, Electromagnetic Compatibility Directive 2014/30/EU, Ecodesign Directive 2009/125/EC, RoHS Directive 2011/65/EU and following amendments.

# TERMS OF KITCHENAID GUARANTEE ("GUARANTEE")

## Covering U.K. - Ireland - UAE

KitchenAid Europa, Inc., Nijverheidslaan 3, Box 5, 1853 Strombeek-Bever, Belgium ("Guarantor") grants the end-customer, who is a consumer, a Guarantee pursuant to the following terms.

### FOR U.K.:

The Guarantee applies in addition to and does not limit or affect the statutory warranty rights of the end-customer against the seller of the product. In summary, the Consumer Rights Act 2015 says products must be as described, fit for purpose and of satisfactory quality. During the expected lifespan of your product your legal rights entitle you to the following:

- Up to 30 days: if your product is faulty, then you can get an immediate refund.
- Up to six months: if your product can't be repaired or replaced, then you're entitled to a full refund, in most cases.
- Up to six years: if your product does not last a reasonable length of time you may be entitled to some money back.

These rights are subject to certain exceptions. For detailed information please visit the Citizens Advice website [www.adviceguide.org.uk](http://www.adviceguide.org.uk) or call **03454 04 05 06**.

### FOR IRELAND:

The Guarantee applies in addition to and does not limit or affect the statutory warranty rights of the end-customer against the seller of the product under the European Communities (Certain Aspects of the Sale of Consumer Goods and Associated Guarantees Regulations 2003 (S.I. No. 11/2003)) and other enactments governing the sale of consumer goods.

### FOR UAE:

The Guarantee applies in addition to and does not limit or affect the statutory warranty rights of the end-customer against the seller of the product.

## 1. SCOPE AND TERMS OF THE GUARANTEE

- a) The Guarantor grants the Guarantee for the products mentioned under Section 1.b) which a consumer has purchased from a seller or a company of the KitchenAid-Group within the following countries: U.K., Ireland, or the United Arab Emirates (UAE).
- b) The Guarantee period depends on the purchased product and is as follows:

#### **One Year full guarantee from date of purchase.**

- c) The Guarantee period commences on the date of purchase, i.e. the date on which a consumer purchased the product from a dealer or a company of the KitchenAid-Group.
- d) The Guarantee covers the defect-free nature of the product.
- e) The Guarantor shall provide the consumer with the following services under this Guarantee, at the choice of the Guarantor, if a defect occurs during the Guarantee period:
  - Repair of the defective product or product part, or
  - Replacement of the defective product or product part. If a product is no longer available, the Guarantor is entitled to exchange the product for a product of equal or higher value.
- f) If the consumer wishes to make a claim under the Guarantee, the consumer has to contact the country specific KitchenAid service centres or the Guarantor directly at KitchenAid Europa, Inc. Nijverheidslaan 3, Box 5, 1853 Strombeek-Bever, Belgium;

Email-Address U.K.: [CONSUMERCARE.UK@kitchenaid.eu](mailto:CONSUMERCARE.UK@kitchenaid.eu)

Email-Address IRELAND: [CONSUMERCARE.IE@kitchenaid.eu](mailto:CONSUMERCARE.IE@kitchenaid.eu)

Toll Free Number U.K. & IRELAND: **00 800 381 040 26**

### FOR UAE:

#### **AL GHANDI ELECTRONICS.**

POST BOX NO. 9098,

DUBAI, UNITED ARAB EMIRATES

Toll free number: +971 4 2570007

- g) The costs of repair, including spare parts, and any postage costs (if applicable) for the delivery of a defect-free product or product part shall be borne by the Guarantor. The Guarantor shall also bear the postage costs for returning the defective product or product part if the Guarantor or the country specific KitchenAid customer service centre requested the return of the defective product or product part. However, the consumer shall bear the costs of appropriate packaging for the return of the defective product or product part.
- h) To be able to make a claim under the Guarantee, the consumer must present the receipt or invoice of the purchase of the product.

## 2. LIMITATIONS OF THE GUARANTEE

- a) The Guarantee applies only to products used for private purposes and not for professional or commercial purposes.
- b) The Guarantee does not apply in the case of normal wear and tear, improper or abusive use, failure to follow the instructions for use, use of the product at the wrong electrical voltage, installation and operation in violation of the applicable electrical regulations, and use of force (e.g. blows).
- c) The Guarantee does not apply if the product has been modified or converted, e.g. conversions from 120 V products to 220-240 V products.
- d) The provision of Guarantee services does not extend the Guarantee period, nor does it initiate the commencement of a new Guarantee period. The Guarantee period for installed spare parts ends with the Guarantee period for the entire product.
- e) **FOR UAE ONLY:**  
Further or other claims, in particular claims for damages, are excluded unless liability is mandatory by law.

After expiry of the Guarantee period or for products for which the Guarantee does not apply, the KitchenAid customer service centres are still available to the end-customer for questions and information.

Further information is also available on our website:

- For U.K. & Ireland [www.kitchenaid.eu](http://www.kitchenaid.eu)
- For UAE: [www.KitchenAid-MEA.com](http://www.KitchenAid-MEA.com)

# PRODUCT REGISTRATION

Register your new KitchenAid appliance now: <http://www.kitchenaid.eu/register>