

TR MONTAJ BİLGİ SAYFASI

Ocak üzerindeki kap destek yüzeyleri ve ocak davlumbazının en alt kısmı arasındaki mesafe elektrikli ocaklar için 50 cm ve gazlı veya ikisi bir arada ocaklar için 65 cm altında OLMAMALIDIR. Gazlı ocakların montaj talimatlarında daha fazla mesafe bırakılması isteniyorsa, bu mesafeye uyulmalıdır. Montaj için yetkili bir teknisyene başvurun. Cihazı monte ederken numaralandırılmış adımları takip edin (1⇒2⇒3⇒.....).

Montaj işlemi tamamlanmadan, fişi prize takmayın.

! UYARI: Boşaltım borusu ve kelepçelerin donanımıyla birlikte temin edilip edilmediğini kontrol ediniz. Eğer temin edilmemişse, ayrıca satın alınmalıdırlar.

Not: Özel olarak “(*)” sembolü ile işaretli olan parçalar sadece bazı modellerde bulunan veya bulunmayan modellerde ayrıca satın alınabilen opsiyonel aksesuarlardır.

Ürün çok ağırdır; davlumbazın taşınma ve montajı en az iki kişi tarafından yapılmalıdır.

GB INSTALLATION DATA SHEET

The minimum distance between the support surface of the recipients on the cooking device and the lowest part of the hood **MUST NOT BE** less than 50 cm in the case of electric cookers and 65 cm for gas or combination cookers.

If the installation instructions for a gas cooker specify a greater distance, then this distance must be observed. It is advisable to contact a qualified technician for installation. To install, follow steps (1⇒2⇒3⇒.....). Do not connect the hood to the electrical power supply until installation is completed.

! WARNING: Check whether the exhaust pipe and clamps are provided. If not, they must be purchased separately.

Note: Parts marked with the symbol “(*)” are optional accessories supplied only with some models or parts not supplied, to be purchased separately.

Very heavy product; hood handling and installation must be carried out by at least two persons.

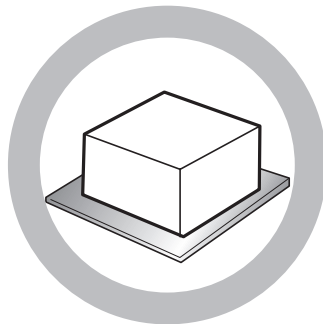
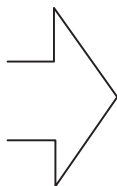
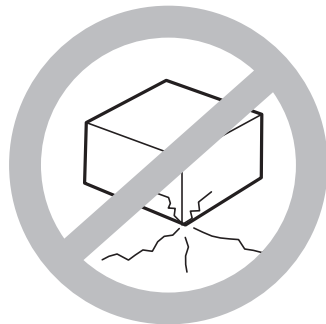
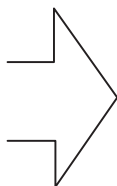
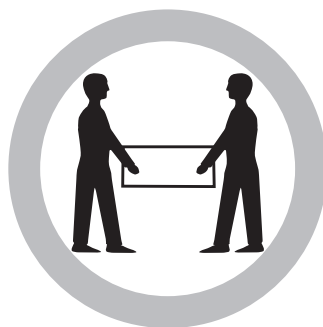
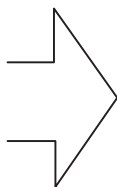

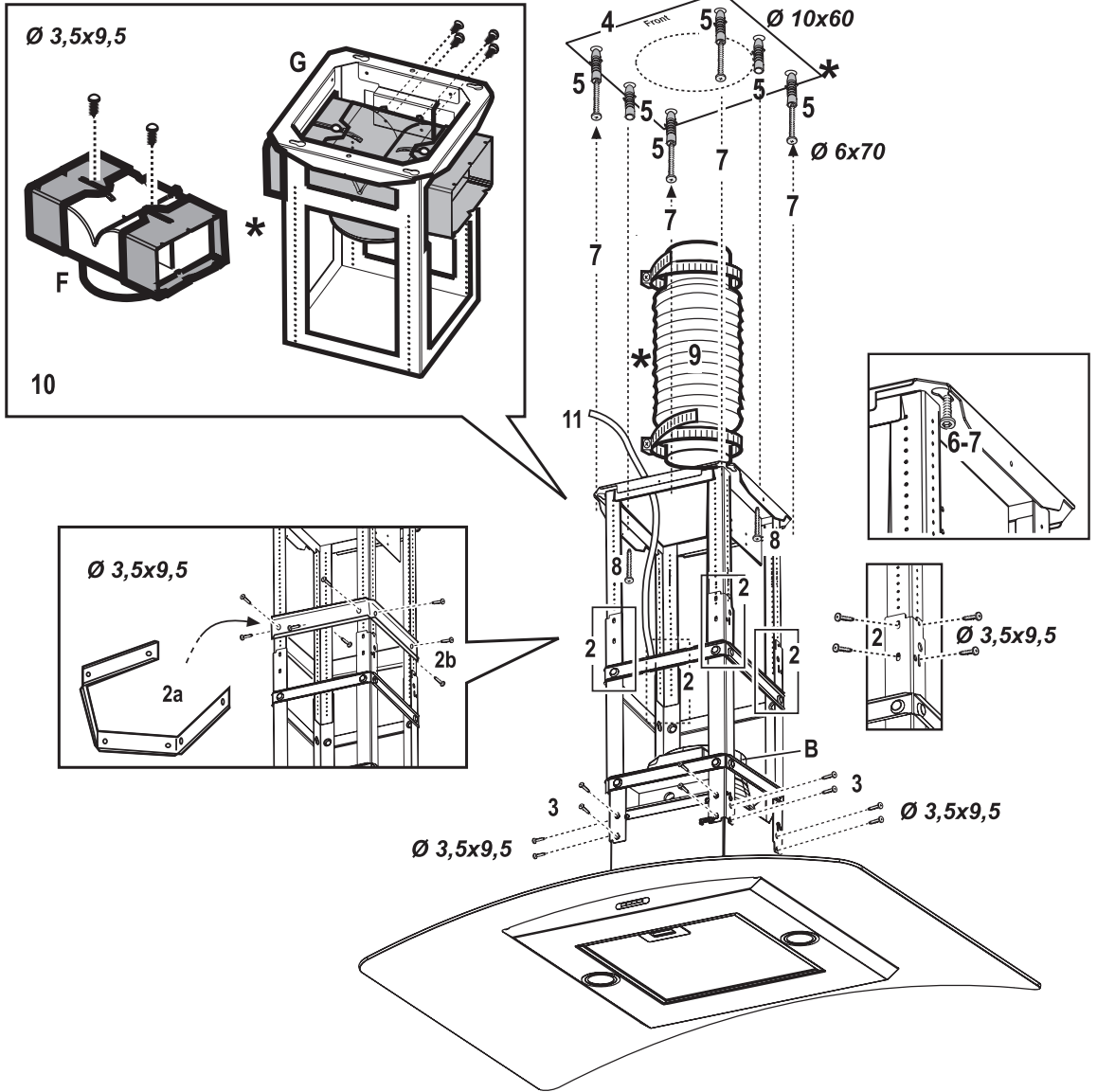

Şekil 1
Fig. I

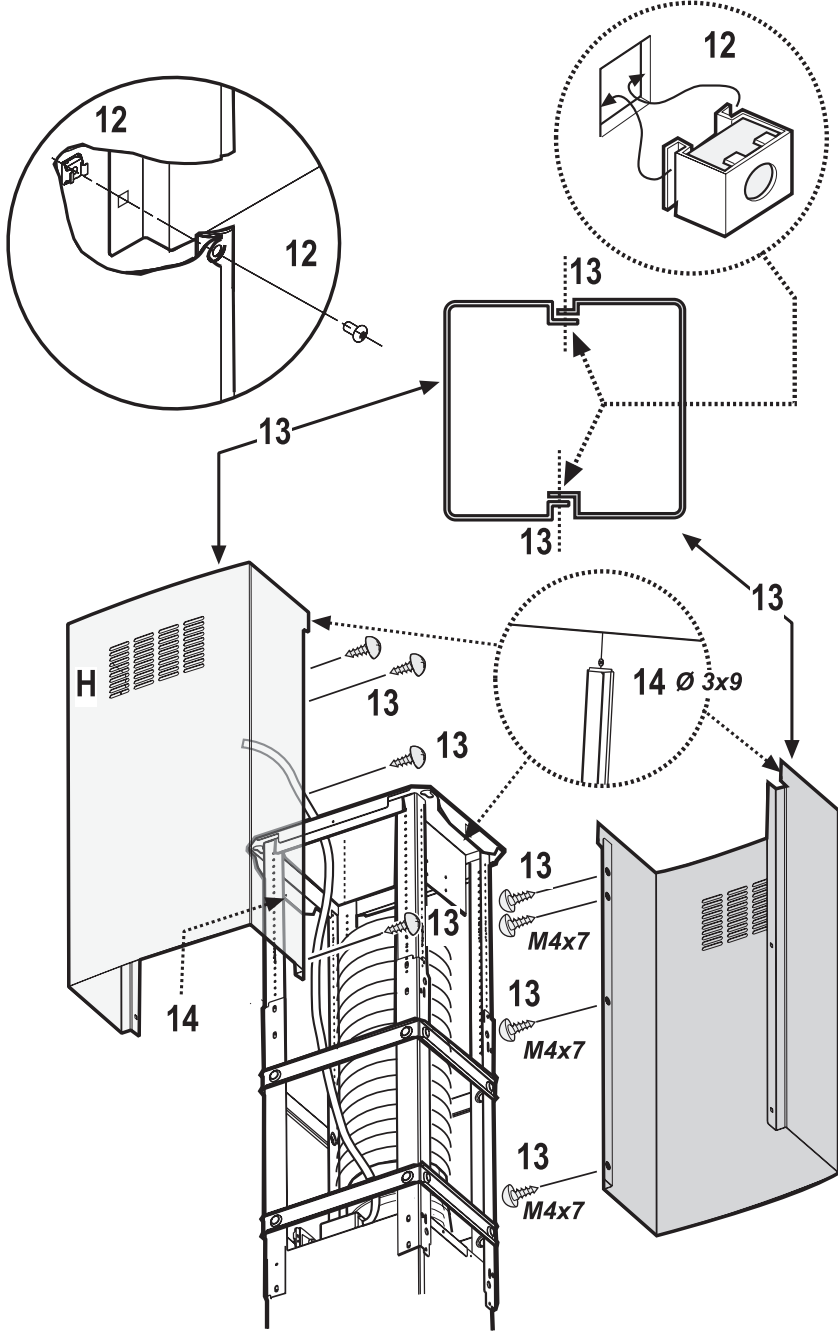

Şekil 2
Fig. 2

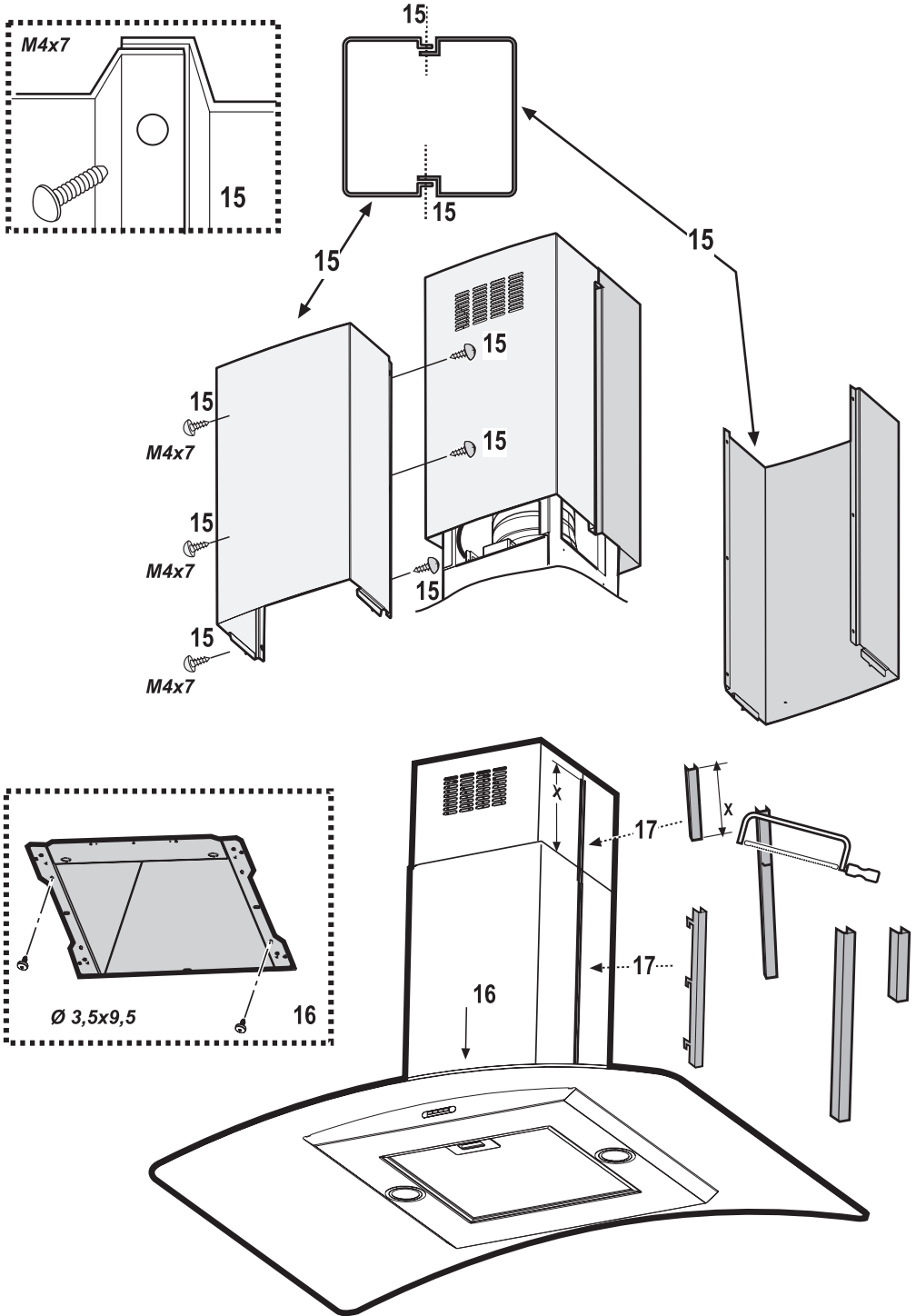

Şekil 3
Fig. 3

SAFEGUARDING THE ENVIRONMENT

1. Packing

Packing materials are 100% recyclable and are marked with the recycling symbol . Comply with the local regulations for disposal. The packing materials (plastic bags, polystyrene, etc.) are a potential source of danger and must be kept out of the reach of children.

2. Product

This appliance is marked in compliance with European Directive 2002/96/EC, Waste Electrical and Electronic Equipment (WEEE). By ensuring that this appliance is correctly scrapped, the user can help prevent potentially harmful consequences for the environment and the health of people.

The symbol  on the product or the accompanying documentation indicates that this product should not be treated as domestic waste but must be taken to a suitable collection centre for the recycling of electrical and electronic equipment. Disposal must be carried out in compliance with local regulations on waste disposal.

For further information on the treatment, recovery and recycling of this product, contact the competent local office, the household waste collection service or the shop where you purchased the appliance.



IMPORTANT INSTRUCTIONS FOR SAFETY

 **WARNING:** To reduce the risk of accidents, electric shock, injury or damage, when using the hood comply with the basic precautions, including the following.

1. Always disconnect the hood from the power supply before carrying out any installation or maintenance operation on the appliance.
2. Installation must be carried out by a specialised technician, in compliance with the manufacturer's instructions and local safety regulations.
3. Earthing of the appliance is compulsory. (Not possible for Class II hoods).
4. Never use multisoquets and extension leads.
5. The electrical components must no longer be accessible to the user after installation.
6. Do not touch the hood with wet parts of the body or use it when barefoot.
7. Do not pull the appliance power cable to unplug it.
8. After-sales service – do not repair or replace any part of the hood unless specifically indicated in the manual. All other maintenance services must be carried out by a specialised technician.
9. When drilling the wall, make sure not to damage the electrical connections and/or pipes.
10. The ventilation ducts must always discharge to the outside.
11. The Manufacturer declines any liability for improper use or incorrect setting of the controls.

12. The appliance is not intended for use by children or persons with limited physical, sensory or mental abilities or without experience and knowledge of it, unless they are under the supervision of or instructed in its use by a person responsible for their safety.
13. Keep children away.
14. To reduce the risk of fire, only use a metal inlet duct.
15. Children must be supervised so that they do not play with the appliance.
16. The product must be disposed of in compliance with local regulations on waste disposal.
17. For further information on the treatment, recovery and recycling of this product, contact the competent local office, the household waste collection service or the shop where you purchased the appliance.
18. Regular cleaning and maintenance is essential for correct hood operation and good performance. Frequently clean all encrustations from dirty surfaces to prevent the accumulation of grease. Regularly clean or replace filters.
19. Do not "flambé" food under the hood. Naked flames could cause a fire.
20. The room must have adequate ventilation when the hood is used at the same time as appliances operating on gas or other fuels.
21. The discharge air must not be eliminated in a duct used to remove fumes produced by appliances operating on gas or other fuels, but must have a separate outlet. All the national regulations on air discharge envisaged by art. 7.12.1 of CEI EN 60335-2-31 must be observed.
22. If the hood is used together with other appliances operating on gas or other fuels, the negative pressure in the room must not exceed 4 Pa (4×10^{-5} bar). Therefore, make sure the room is adequately ventilated.
23. Do not leave pans unattended when frying, since the cooking oil could catch fire.
24. Make sure the lamps are cold before touching them.
25. The hood is not a shelf, therefore do not overload or place objects on it.
26. Do not use or leave the hood without its lamps correctly installed - risk of electric shock.
27. Wear work gloves for all installation and maintenance operations.
28. The product is not suitable for outdoor use.
29. The air sucked by the hood must not be eliminated through the same flue of the heating system or other appliances using gas or other fuels.

Electrical connection

The mains voltage must match that given on the rating plate located inside the hood. If provided with a plug, connect the hood to a socket complying with the current regulations and located in an accessible area. If it does not have a plug (direct connection to the power supply) or if the plug is not in an accessible place, fit a suitable double-pole switch that ensures complete disconnection from the power supply in category III overvoltage conditions, complying with the installation rules.

⚠ WARNING: Before reconnecting the hood circuit to the power supply and checking correct operation, always make sure the power cable is correctly fitted and that it was NOT crushed in its housing during installation. Make sure to have this operation carried out by a specialised technician.

Cleaning the hood

⚠ WARNING! Failure to remove oil/grease (at least once a month) could result in fire.

Use a soft cloth with a neutral detergent. Never use abrasive substances or alcohol.

Before using the hood

Please read these instructions carefully and keep them for future reference, in order to ensure best use of your hood.

The packing materials (plastic bags, polystyrene, etc.) are a potential source of danger and must be kept out of the reach of children.

Make sure the hood has not been damaged during transport.

Declaration of conformity

This product has been designed, manufactured and put on the market in conformity with:

- safety objectives of the "Low Voltage" Directive 2006/95/EC (which replaces 73/23/EEC as amended)
- protection requirements of "EMC" Directive 89/336/EEC amended by Directive 93/68/EEC.

Troubleshooting guide

If the hood does not work:

- Is the plug properly inserted in the power socket?
- Is there a power failure?

If the hood is not extracting enough:

- Is the right speed selected?
- Do the filters need cleaning or replacing?
- Are the air outlets blocked?

If the lamp does not work:

- Does the lamp need replacing?
- Is the lamp correctly fitted?

AFTER-SALES SERVICE

Before calling the After-Sales Service

1. Check to see if you can fix the problem yourself (see "Troubleshooting Guide").
2. Switch the appliance off and then on again to check if the problem has been eliminated.
3. If the problem persists, contact the After-Sales Service.

Specify:

- the type of fault,
- the product model given on the dataplate inside the hood, visible on removing the grease filters,
- your full address,
- your telephone number and area code,
- the Service code (the number under the word SERVICE on the dataplate inside the hood, behind the grease filter).

If any repairs are necessary, contact an authorised Service Centre (to ensure the use of original spare parts and correct repair). Failure to comply with these instructions can compromise the safety and quality of the product.

SERVICE



INSTALLATION - ASSEMBLY INSTRUCTIONS

Expansion plugs are provided to secure the hood to most types of ceilings. However, a qualified technician is needed to make sure that the plugs are suitable for your ceiling. The wall/ceiling must be strong enough to take the weight of the hood. Disconnect the power supply at the home main switch during electrical connections.

FIG.1

1. Adjust the extension of the hood support structure, as the final height of the hood depends on this.
Note: In some cases the top section of the truss is fixed to the bottom section with 1 or more screws. Check for and temporarily remove any screws to enable adjustment of the support structure.
2. Fix the two sections of the structure using 16 screws (4 each corner).
For extension beyond the minimum height, fit 1 or 2 brackets (depending on how many are supplied) to the top section to reinforce it.
Note: for transport purposes, 1 bracket may be temporarily fixed to the truss already with 2 screws; if so, move it to the desired position and complete the fixing with a further 6 screws.
To fit the brackets, proceed as follows:
 - a. Open the brackets slightly in order to fix them to the outside of the structure.
 - b. Position the reinforcement bracket directly above the point where the two sections of the hood are joined and secure with 8 screws (2 each corner).
If supplied, fix the second reinforcement bracket so that it is equidistant from the first reinforcement bracket and the top edge of the truss, secure with 8 screws (2 each corner).
Note: when positioning the reinforcement bracket/s, make sure they do not hinder fixture of the exhaust pipe (extractor version) or the deflector (filter version).
3. Hook the hood to the truss, check for perfect hooking - to hook the hood to the truss tighten the 16 screws (4 each corner).
4. Place the ceiling hole diagram directly above the cooktop (the centre of the diagram must match the centre of the cooktop and the edges must be parallel to the sides of the cooktop - the side of the diagram with the wording FRONT corresponds to the control panel side). Prepare the electrical connection.
5. Drill as shown (6 holes for 6 wall plugs - 4 plugs for hooking), screw the 4 outer screws leaving a space of about 1 cm between the screw head and the ceiling.
6. Hook the truss on the ceiling to the 4 screws (see step 4).
7. Tighten the 4 screws.
8. Insert and tighten another 2 screws in the remaining free holes for secure fixing.
9. Fit an exhaust duct inside the truss and connect it to the collar of the motor compartment (exhaust pipe and clamps are not provided). The exhaust duct must be long enough to vent externally (Extractor version) or reach the deflector **F** (Filter version).
10. For Filter Version only: fit the deflector **F** sul on the truss and fix it to the bracket with 4 screws, then connect the exhaust duct to the collar on the deflector.
11. Carry out the electrical connection to the mains power supply, only turn on the power supply with assembly completed.

FIG.2

12. Fit the nuts with fixing hooks supplied inside the top and bottom sections of the flues at the rectangular slots. A total of 14 nuts must be fitted.
13. Join the two top sections of the flue to cover the truss so that one of the slots on the sections is on the same side as the control panel and the other is on the opposite side.
Screw the two sections with 8 screws (4 each side - see the plan diagram for joining the two sections).
14. Fix the top flue assembly to the truss, near the ceiling, with two screws (one each side).

FIG.3

15. Join the two bottom sections of the flue covering the truss using 6 screws (3 each side - also see the plan diagram for joining the two sections).
16. Insert the bottom section of the flue in its seat so that it completely covers the motor compartment and electrical connection box, then secure it from inside the hood using two screws.
17. Apply the 2 tabs (supplied) to cover the fixing points of the bottom flue sections
(IMPORTANT! THE TABS FOR THE BOTTOM FLUE ARE THE NARROWER AND LESS DEEP ONES).
The wider and deeper tabs are those used for the top flue, and must be cut to size.
18. Turn the mains power on again at the central electrical panel and check for correct hood operation.

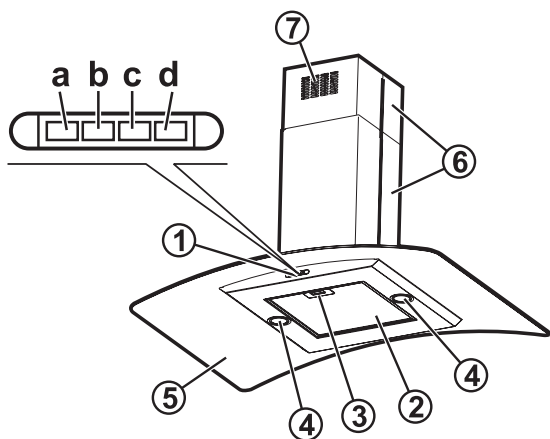

I. Control panel

- a. Light switch
- b. Extraction and minimum extraction speed ON/OFF switch.
- c. Medium extraction speed switch.
- d. Maximum extraction speed switch.

2. Grease filter

3. Grease filter release handle

4. Halogen bulb

5. Steam deflector

6. Telescopic flue

7. Air outlet (for filter version only)

Grease filters:

Metal grease filters have an unlimited life and should be washed once a month either by hand or in a dishwasher at a low temperature and with a short cycle. Washing in a dishwasher can cause grease filters to turn white, but this in no way affects efficiency.

- a. press the handle to remove the filter
- b. remove it.

Wash the filter and leave it to dry, proceeding in reverse order to refit it.

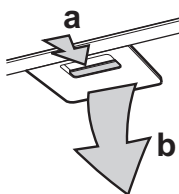

Replacing the halogen bulbs:

1. Disconnect the hood from the mains power supply.
 - ⚠ **WARNING:** Wear gloves.
 2. Use a small screwdriver to gently prise the lamp cover off (at the points indicated in Figure).
 3. Remove the burnt-out lamp and fit a new one.
 - ⚠ **WARNING:** Replace using 20W max G4 halogen bulbs only.
- Close the lighting unit (snap-on).

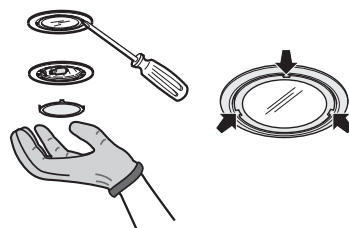

Active carbon filter (filter hoods only):

The carbon filter must be cleaned once a month in a dishwasher at the highest temperature, using a normal dishwasher detergent. Wash the filters on their own. After washing, reactivate the carbon filter by drying it in the oven at 100°C for 10 minutes. Change the carbon filter every 3 years

Fitting the carbon filter:

1. Remove the grease filter.
 2. Remove the filter holder by turning the knobs 90°.
 3. Fit the carbon filter "i" in the filter holder "h".
- Reverse the above procedure to re-fit the filter holder and grease filter.

