



**THANK YOU FOR BUYING A WHIRLPOOL PRODUCT**  
 In order to receive a more complete assistance, please register your product on [www.whirlpool.eu/register](http://www.whirlpool.eu/register)



**Before using the appliance carefully read the Safety Instruction.**

## PRODUCT DESCRIPTION

### APPLIANCE

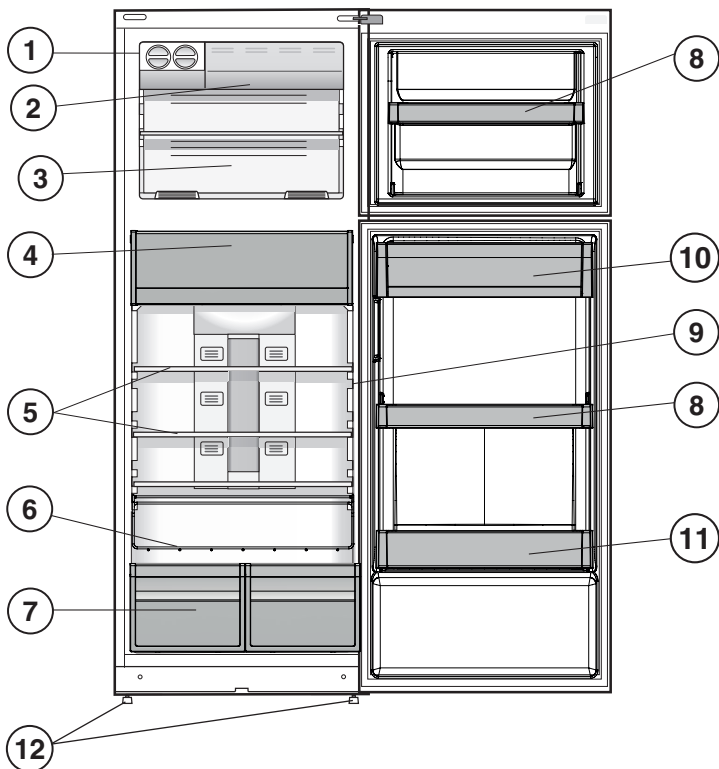

1. Ice Device \*
2. Quick Freezer \*
3. Freezer And Storage Compartment
4. Food Care Zone 0 °C / Safe Defrost \*
5. Shelves \*
6. Bottle Rack \*
7. Fruit And Vegetable Bin \*
8. Movable Shelves \*
9. Temperature Indicator \*
10. Dairy Shelf \*
11. Bottle Shelf
12. Levelling Feet

\* Varies by number and/or position, available only on certain models.

### CONTROL PANEL

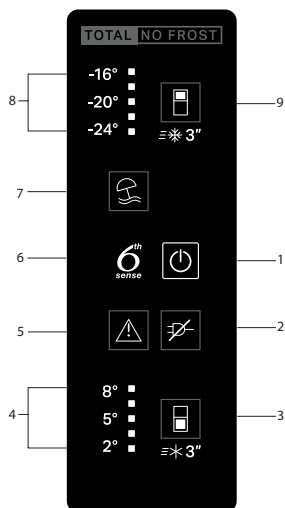

1. ON/STANDBY Indicator and Button
2. Black Out Alarm Long Black-Out Alarm Indicator (see the below Alarm Table)
3. Fridge Temperature / Fast Cool button
4. Fridge Temperature Leds
5. Stop Alarm Button (see the below Alarm Table)
6. 6<sup>th</sup> Sense Indicator
7. Vacation (Holiday) Mode
8. Freezer Temperature Leds
9. Freezer Temperature / Fast Freeze button

# ACCESSORIES

## EASY ICE

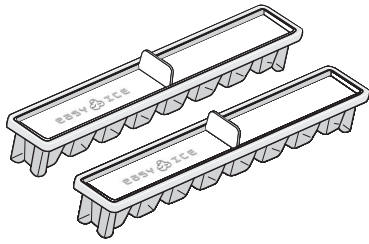

## BOTTLE RACK

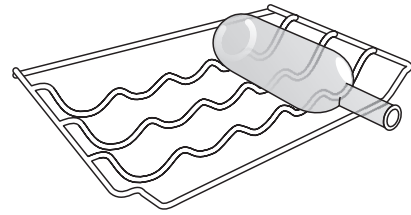

# FIRST TIME USE

## HOW TO START THE APPLIANCE

After plugging the appliance to the mains, it starts the operation automatically. After starting the appliance, wait at least 4-6 hours before placing food into the fridge and into the freezer compartment.

When the appliance is connected to the power supply, the display lights up and all the icons appear on the display for approximately 1 second. The default (factory) values of the fridge - freezer compartment settings light-up.

# DAILY USE

See Use and Care Guide for more details on functions / see last page for information on how to obtain the Use and Care Guide

## FUNCTIONS

### ON/STANDBY INDICATOR /BUTTON

To put the product in Stand-by, press and hold for 3 seconds. All the icons turn off except.



disabled after 48 hours, or can be manually disabled by pressing Freezer °C button.



### FRIDGE TEMPERATURE

To adjust the Fridge Temperature, press the Fridge °C button. The Fridge Temperature can be adjusted between +2°C and + 8°C, as shown by the Fridge Temperature LEDs.

### FAST COOL

Using Fast Cool function it is possible to increase the cooling in the refrigerator compartment. The use of this function is recommended when placing a very high quantity of food in the refrigerator compartment. Press & hold for 3 sec. the Fridge °C button to activate Fast Cool function. When activated, the Fast Cool indication will be displayed by the Fridge Temperature LEDs as shown in the beside sequence. The function is automatically disabled after 6 hours, or can be manually disabled by pressing Fridge °C button.



### VACATION BUTTON

This function can be activated to reduce the energy consumption of the appliance during a prolonged period of time. Before activating the feature, all perishable food should be removed from the refrigeration compartment and make sure that the door is closed properly, since the refrigerator will maintain a suitable temperature to prevent the formation of unpleasant odors (+12°C). To activate/ deactivate press the Vacation mode button for 3 seconds. When the function is enabled, the related symbol will light up and the temperature of the refrigerator compartment will be set to a higher setpoint (the temperature display will show the new temperature setpoint of +12°C). Changing the temperature setpoint will automatically deactivate the function.



### FREEZER TEMPERATURE

To adjust the Freezer Temperature, press the Freezer °C button. The Freezer Temperature can be adjusted between -16°C and -24°C, as shown by the Freezer Temperature LEDs.

### FAST FREEZE

The use of this function is recommended when placing a very high quantity of food to be frozen in the freezer compartment. 24 hours before freezing fresh food, press & hold for 3 sec. the Freezer button to activate the Fast Freeze function. When activated, the Fast Freeze indication will be displayed by the Freezer Temperature LEDs as shown in beside sequence. After 24 hours place the food to be frozen in the upper basket of freezer compartment. The function is automatically

### 6<sup>TH</sup> SENSE INDICATOR

6<sup>th</sup> Sense technology automatically works to ensure the optimal conditions to preserve the stored food.

### SMART DISPLAY

This optional function can be used to save energy. To activate the Smart Display, press Fridge °C and Freezer °C buttons at the same time for 3 seconds until an audible signal sounds. To deactivate this function repeat the same procedure. Remember that this function does not disconnect the appliance from the power supply, but only reduce the power consumed by external display.

### FOOD CARE ZONE 0 °C / SAFE DEFROST \*

A compartment designed to keep delicate food such as meat and fish fresh. The low temperature in the compartment makes

it possible to store the food for up to one week - tests performed on meat products - without changing its nutrients, appearance and flavour. The compartment is also very suitable for healthy food defrosting, as low-temperature defrosting prevents any proliferation of microorganisms, while protecting its taste and organoleptic properties. It is not suitable for fruit, vegetables and green salad. But it can be used for stuffed fresh pasta and even cooked food or leftovers.

**TEMPERATURE INDICATOR \***

Temperature indicator informs you if the temperature in this cavity is cold enough for storage with the word "OK".

1. Check that OK appears clearly on the indicator light (see the picture below).



2. If the word "OK" does not appear it means that the temperature is too high: set a lower temperature and wait approximately 10 hours until the temperature has been stabilised.
3. Check the indicator light again: if necessary, readjust it following the initial process. If large quantities of food have been added or if the refrigerator door has been opened frequently, it is normal for the indicator not to show OK. Wait at least 10 hours before adjusting the REFRIGERATOR OPERATION knob to a higher setting.

**SHELVES \***

Due to the special guides the shelves are removable and the height is adjustable, allowing easy storage of large containers and food.

**FRUIT AND VEGETABLE BIN \***

The salad crispers fitted inside the fridge have been specially designed for the purpose of keeping fruit and vegetables fresh and crisp. Open the humidity regulator (position B) if you want to store food in a less humid environment like fruit, or close it (position A) to store food in a more humid environment like vegetable.

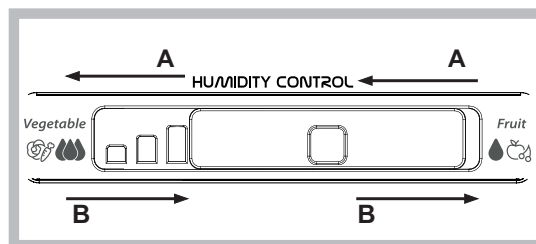

**ICE DEVICE \***

After pouring water in the special ice cups, place them in their places in the ice device. After about 2 hours, the ice cubes will be ready. In order to get the ice cubes, it will be sufficient to turn the two buttons to the right. The ice cubes will fall in to the tray below, ready to be used.

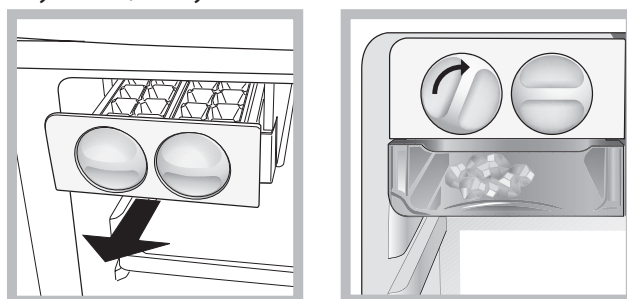

**ALARM TABLE**

ALARM TYPE	SIGNAL	CAUSE	SOLUTION
Door open alarm	The acoustical alarm is activated and the Alarm Indicator  blinks.	The door has remained open for more than 2 minutes.	Close the door or press the Stop Alarm to mute the acoustical alarm.
Temperature Alarm	The Temperature LEDs display blinks (°C) and the Alarm Indicator  remains on.	The inside freezer temperature is not adequate.	Press the Stop Alarm button ; the acoustical alarm stops, the Temperature Display (°C) blinks and the Alarm Indicator  remains on until a temperature < -10°C is reached.
Long Black-Out alarm	The Black Out Alarm icon  remains on, the Alarm indicator  blinks	Prolonged power failure, able to cause the inside temperature to increase to 0°C.	Press the Stop Alarm button ; the acoustical alarm stops, the Temperature Display (°C) blinks and the Alarm Indicator  remains on until a temperature < -10°C is reached.

**SOME OF THE FUNCTIONAL SOUNDS YOU MIGHT HEAR**

A hissing sound when switching on the appliance for the first time or after a long pause.



A gurgling sound when refrigerant fluid enters into the pipes.

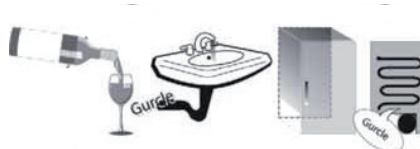

BRRR sound is from the compressor running.



Buzzing sound when water valve or fan start working.



A cracking sound when compressor starts.



The CLICK is from the thermostat which adjusts how often the compressor is running.



# HOW TO STORE FOOD AND BEVERAGE

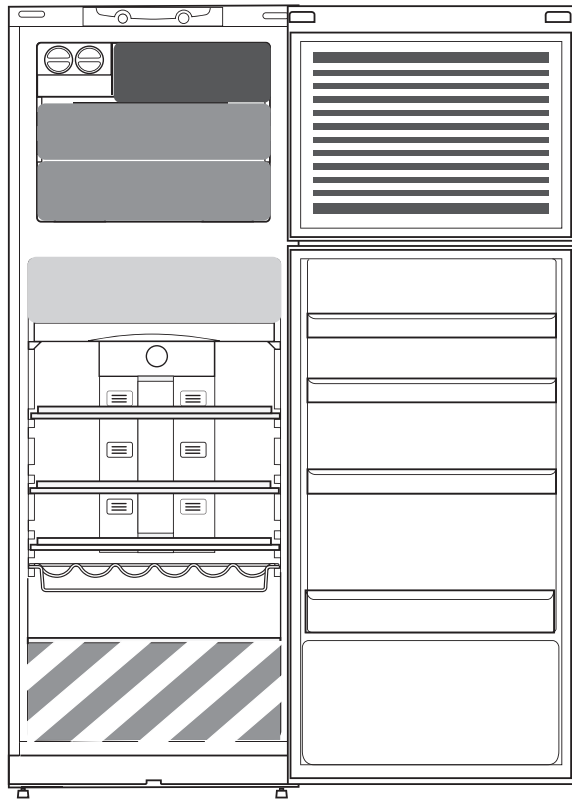

## Legend



### COOL ZONE

Suggested for the storage of beverage, milk and food as dairy food, delicatessen, yogurt, eggs, butter, sauces, pickles, desserts

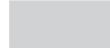

### COOLER ZONE:

#### FOOD CARE ZONE 0 °C / SAFE DEFROST \*

Suggested for the storage of meat, fish, cold cuts, stuffed fresh pasta, cooked food, leftovers. This zone is also suggested for food defrosting.



### FRUIT & VEGETABLE DRAWER



### FAST FREEZING ZONE DRAWER

Max cool zone suggested to freeze fresh food and cooked food.



### NORMAL FREEZER DRAWERS

Suggested for the storage of frozen food and ice cream.



### ICE CREAM LOADING IN THE BALCONIES AREA

Note: The Grey tone of the legend doesn't match with the color of drawers

## FRIDGE COMPARTMENT

Use recyclable plastic, metal, aluminum and glass containers and cling film to wrap foods.

Always use closed containers for liquids and for food that may give off or be tainted by odor or flavor transfer or cover them.

If you have a little quantity of food to store in the refrigerator, we recommend to use the shelves above the crisper for fruits and vegetables since this is the coolest area of the compartment.

Foods which give off a large amount ethylene gas and those that are sensitive to this gas, such as fruit, vegetables and salad, should always be separated or wrapped so as not to reduce the storage life; for example do not store tomatoes together with kiwi fruits or cabbage.

To avoid bottles falling over, you can use the bottle holder (available on selected models).

Do not store food too close together to enable sufficient air circulation.

## FREEZER COMPARTMENT

The freezer is the ideal storage location for store frozen food, make ice cubes and freeze fresh food in the freezer compartment.

The maximum number of kilograms of fresh food that can be frozen within a 24-hour period is indicated on the rating plate (...kg/24h).

If you have a little quantity of food to store in the freezer, we recommend to use the coldest areas of your freezer compartment, corresponding to the middle area.



You can download the Safety Instructions, User Manual, Product Fiche and Energy data by:

- Visiting our website [docs.whirlpool.eu](http://docs.whirlpool.eu)
- Using QR Code
- Alternatively, **contact our After-sales Service** (See phone number in the warranty booklet). When contacting our After-sales Service, please state the codes provided on your product's identification plate.

