



THANK YOU FOR BUYING A WHIRLPOOL PRODUCT
In order to receive a more complete assistance, please register your product on www.whirlpool.eu/register



Before using the appliance carefully read the Safety Instruction.

PRODUCT DESCRIPTION

FIRST TIME USE

Wait at least two hours, after the installation, before connecting the appliance to the power supply. Connect the appliance to the power supply it starts the operation automatically. The ideal storage temperatures for the food are preset in the factory.

After turning the appliance on, you must wait for 4-6 hours for the correct storage temperature to be reached for a normally filled appliance. Position the antibacterial anti-odour filter in the fan as demonstrated in the filter packaging (if available). If the audible signal sounds, it means that the temperature alarm has intervened: press the button to switch off the acoustic alarms.

CONTROL PANEL

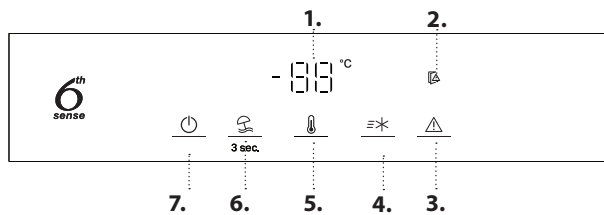

1. Temperature Display
2. Door open indicator
3. Turning off the sound alarm
4. Fast cool
5. Temperature button
6. Vacation Mode
7. On/stand-by

6th SENSE FRESH CONTROL AND FREEZE CONTROL

The appliance is automatically able to quickly reach the optimal internal preservation temperature.

FAN*

The Fan improves temperature distribution inside the refrigerator compartment, allowing better preservation of stored food. The fan will start/stop working depending on the temperature and/or humidity level inside the fridge. If the appliance has the Fan it can be equipped with the antibacterial filter.

Note: the fan restarts automatically after a power cut or after turning off the appliance. Do not obstruct the air intake area with food items.

ANTIBACTERIAL FILTER*

Remove it from the box placed in the Fruit and vegetable drawer and insert into the cover of fan. The replacement procedure is included in the filter box.

3 sec ON/STAND-BY

To put the product in Stand-by, press and hold the On/ Stand By button. All the indicators turn off except On/Standby indicator. In Stand-by mode the light in the refrigerator compartment does not turn on Press again to reactivate the appliance.

Note: this does not disconnect the appliance from the power supply.

TEMPERATURE DISPLAY

The display shows the refrigerator compartment temperature (between 2°C and 8°C).

To avoid food waste, please refer to the recommended setting and storage times found in the online user manual.

FRIDGE COMPARTMENT TEMPERATURE

To adjust the Fridge Temperature, press the Fridge  button. The Fridge Temperature can be adjusted between +2°C and +8°C, as shown by the Fridge Temperature display. Recommended setting for the refrigerator compartment is +4°C.

FAST COOL FUNCTION (FAST COOLING)

To quickly cool the refrigerator compartment, or 6 hours before putting a large quantity of food to be frozen in the freezer compartment, turn on the "Fast Cooling" function by repeatedly pressing the button until the 3 icons flash green and then stay constant.

The function automatically turns off after 30 hours for appliances with freezer compartment, after 6 hours for appliances without freezer compartment and the temperature returns to the previous setting when the function is turned on.

To turn the function off manually, press the button.

Note: avoid a direct contact between the fresh food and the food that is already frozen.



TURNING OFF THE SOUND ALARM

To turn off the sound alarm, briefly press the  button.

3 sec VACATION

You can use this function in the event of a prolonged absence from home. Press the Vacation button for 3 sec to engage Vacation Mode.

The display will show the temperature of the refrigerator compartment (+12°C) and the Vacation mode icon will light up. After activating this function, remove the food from the refrigerator compartment and keep both doors closed - the refrigerator will maintain a suitable temperature to prevent odours from forming. When you activate vacation mode, remember to remove food from the freezer compartment. A deep clean (of both refrigeration and freezer compartment) is recommended before activating this function in order to prevent the spread of bacteria. Press again the same button for 3 sec to deactivate Vacation. Changing the setpoint will automatically deactivate the function.

* Available only on certain models

HOW TO STORE FOOD AND BEVERAGE

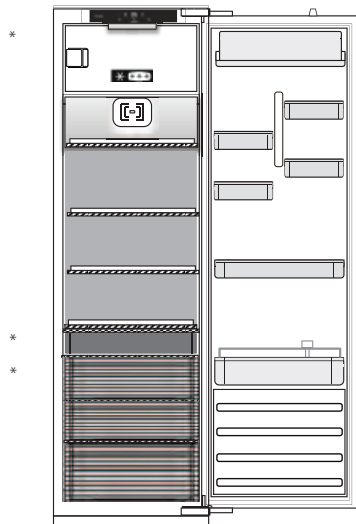

Legend



TEMPERATE ZONE

Suggested for storage of tropical fruit, cans, drink, eggs, sauces, pickles, butter, jam



COOL ZONE

Suggested for storage of cheese, milk, daily food, delicatessen, yoghurt



COOLEST AREA

Suggested for storage of cold cuts, desserts, meat and fish



FRUIT & VEGETABLE DRAWER

FRESH BOX 0**

The drawer is specifically designed to maintain a low temperature to preserve fresh food for longer time (for example, fresh pasta, sour cream, pesto/salsa, homemade preparation, pastry cream, pudding, cream cheese, cold cuts, desserts, meat and fish).

The internal temperature of the drawer is between +3 °C and -2 °C. For the correct functioning of the drawer, it is necessary that Vacation mode option is not selected.

HUMIDITY CONTROL*

Selector of Humidity level in fruit & vegetable drawer: slide the selector to adjust the right level of humidity for the best preservation of the

food you store in.

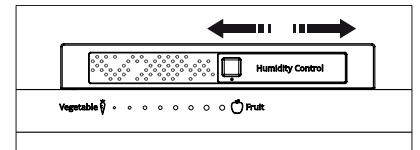
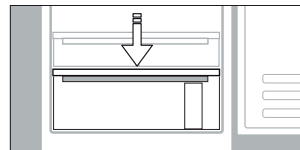

Light system (depending on model)

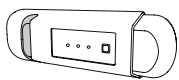

This product contains a light source of energy efficiency class G

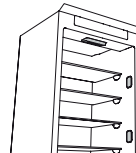

This product contains 2/4 lateral light sources of energy efficiency class F and a top light source of energy class G

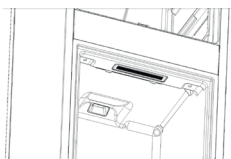

This product contains a light source of energy efficiency class G



This product contains a top light source of energy efficiency class G

GENERAL INFORMATION

The drawers, baskets and shelves should be kept in their current position unless otherwise specified in this quick guide.

The light system inside the refrigerator compartment uses LED lights, allowing for better lighting than with traditional light bulbs, as well as for very low energy consumption.

DISPOSAL

Doors and lids of the refrigeration appliance should be removed before disposal in the landfill, to avoid children or animals getting trapped inside.



REMOVING THE DRAWERS

Pull the drawers outwards as far as they will go, lift them up and remove them. To get more volume, the freezer compartment can be used without the drawers.

Make sure that the door is closed properly after putting the food back on the grilles/shelves.

* Available only on certain models

TROUBLESHOOTING

What to do if...	Possible reasons	Solutions
The control panel is switched off, the appliance does not work.	The appliance may be in On/Stand-by mode. There may be an appliance power supply problem.	Turn the appliance on pressing the On/Stand-by button. Check that: <ul style="list-style-type: none"> • there is not a power outage; • the plug is properly inserted in the power socket and the mains double-pole switch (if present) is in the correct position (i.e. allows the appliance to be powered); • the household electrical system protection devices are efficient; • the power cable is not damaged.
The inside light does not work.	The light may need to be replaced.	Models with LED lights: contact the authorised Technical Assistance Service.
	The appliance may be in On/Stand-by mode.	Turn the appliance on by briefly pressing the  button (see On/Stand-by function).
The temperature inside the compartments is not low enough.	There could be various causes (see "Solutions").	Check that: <ul style="list-style-type: none"> • the doors close properly; • the appliance is not installed near a heat source; • the set temperature is adequate; • the circulation of air through the ventilation grilles on the base of the appliance is not obstructed.
There is water on the bottom of the refrigerator compartment.	The defrost water drain is blocked.	Clean the defrosting water drain (see section "Cleaning and Maintenance").
The front edge of the appliance, at the door striker seal, is hot.	This is not a defect. It prevents condensation from forming.	No solution is necessary.
Door open alarm indicator and Alarm indicators blink, the acoustical alarm is activated.	Door open alarm The Fridge door remained open for more than 2 minutes	Close the door or press the Stop Alarm to mute the acoustical alarm.
The freezer temperature display blinks, the acoustical alarm is activated and the Alarm Indicator blinks	Blackout alarm Inside the Freezer the temperature is not adequate	Press the Stop Alarm button to stop the acoustical alarm; the freezer temperature display continues blinking and the Alarm Indicator remains on until the adequate temperature in the freezer is restored.
The  icon is lit up (without flashing), a sound signal is activated and the freezer temperature display is flashing.	Freezer compartment temperature alarm The freezer compartment temperature alarm indicates that the compartment is not at the optimum temperature. This may occur: when using for the first time, after defrosting and/ or cleaning, when freezing large quantities of food or when the door to the freezer does not close completely.	To turn off the sound signal, briefly press the "Turn off sound alarm" button (the temperature display will stop flashing). When the optimum temperature conditions have been reached, the red icon will automatically turn off. If the freezer compartment temperature alarm continues, contact the Authorised Technical Assistance Service.
The Party Mode and Alarm Indicators blink, the acoustical alarm is activated.	30 min. elapsed since Party Mode function has been activated. It is time to take out the bottle from the freezer (see Use and Care Guide for more details).	Press the Stop Alarm button to cancel the alarm.

* Available only on certain models



Policies, standard documentation, ordering of spare parts and additional product information can be found by:

- Visiting our website docs.whirlpool.eu and parts-selfservice.whirlpool.com
- Using QR Code
- Alternatively, **contact our After-sales Service** (See phone number in the warranty booklet). When contacting our After-sales Service, please state the codes provided on your product's identification plate.

The model information can be retrieved using the QR-Code indicated on the energy label. The label also includes the model identifier that can be used to consult the <https://eprel.ec.europa.eu> database portal.



Whirlpool



400011725846