

THANK YOU FOR BUYING A WHIRLPOOL PRODUCT.

In order to receive a more complete assistance, please register your appliance on [www.whirlpool.eu/register](http://www.whirlpool.eu/register)



Before using the appliance carefully read the Health and Safety guide.

Before using the machine, it is imperative that the transport bolts are removed. For more detailed instructions on how to remove them, see the Installation Guide.

CONTROL PANEL

1. AUTODOSE button
2. SCROLL UP / SCROLL DOWN buttons
3. ON/OFF button
4. WATER SAVE button and indicator light
5. START/PAUSE button
6. CONFIRM / KEY LOCK button
7. START DELAY button
8. SPIN button
9. TEMPERATURE button
10. CYCLE OPTION MENU / SETTINGS MENU button
11. STEAM HYGIENE button
12. WASH CYCLE SELECTOR KNOB

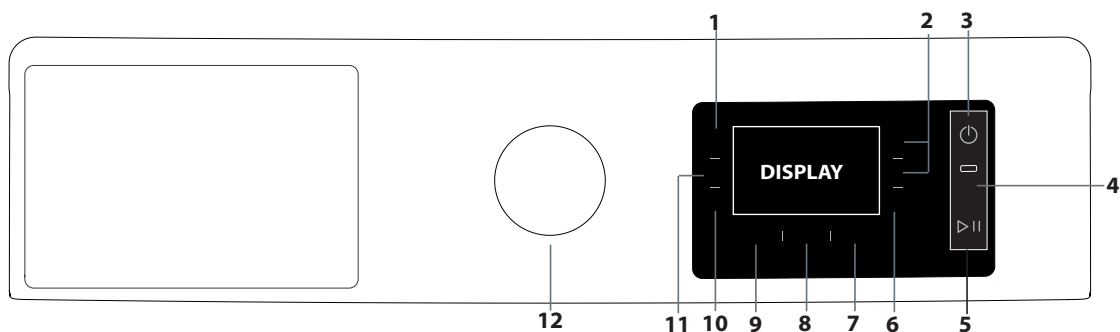

WASH CYCLE TABLE

Wash cycle		Temperature		Max. spin speed (rpm)	Max. load (kg)	Duration (h : m)	WATER SAVE	Pre-wash	Autodose feature		Recommended detergent		Residual dampness % (***)	Energy consumption kWh	Total water l	Laundry temperature °C
		Setting	Range						Wash	Fabric softener	Powder	Liquid				
<b>Mixed Extra Silence</b>	40°C	☼ - 40°C	600	4,0	**	-	✓	-	✓	✓	-	✓	-	-	-	-
<b>Mixed</b>	40°C	☼ - 40°C	1400	10,0	**	✓	✓	-	✓	✓	-	✓	-	-	-	-
<b>Synthetics (3)</b>	40°C	☼ - 60°C	1200	5,5	2:45	✓	✓	✓	✓	✓	✓	✓	35	0,830	56	45
<b>Cotton (2)</b>	40°C	☼ - 90°C	1400	10,0	3:40	✓	✓	✓	✓	✓	✓	✓	49	1,423	100	45
<b>Delicates</b>	30°C	☼ - 30°C	0	1,0	**	-	✓	-	✓	✓	-	✓	-	-	-	-
<b>20°C</b>	20°C	☼ - 20°C	1400	10,0	1:40	✓	✓	-	✓	✓	-	✓	54	0,210	90	22
<b>Wool</b>	30°C	☼ - 30°C	600	2,0	**	-	✓	-	✓	✓	-	✓	-	-	-	-
<b>Spin &amp; Drain *</b>	-	-	1400	10,0	**	-	-	-	-	-	-	-	-	-	-	-
<b>Rinse &amp; Spin</b>	-	-	1400	10,0	**	-	-	-	-	✓	-	-	-	-	-	-
<b>Anti Allergy</b>	60°C	40°C - 60°C	1400	5,5	**	-	✓	-	✓	✓	✓	✓	-	-	-	-
<b>More Cycles</b>																
• <b>Shirts</b>	40°C	☼ - 40°C	600	2,0	**	-	✓	-	✓	✓	-	✓	-	-	-	-
• <b>Jeans</b>	40°C	☼ - 40°C	800	4,0	**	-	✓	-	✓	✓	-	✓	-	-	-	-
• <b>Bed &amp; Bath</b>	60°C	☼ - 60°C	1400	10,0	**	-	✓	-	✓	✓	✓	✓	-	-	-	-
• <b>Duvet</b>	30°C	☼ - 30°C	1000	3,5	**	-	✓	-	✓	✓	-	✓	-	-	-	-
• <b>Silk &amp; Curtains</b>	30°C	☼ - 30°C	-	1,0	**	-	✓	-	✓	✓	-	✓	-	-	-	-
• <b>Baby</b>	40°C	☼ - 40°C	800	4,0	**	-	✓	-	✓	✓	-	✓	-	-	-	-
• <b>Cuddly Toys</b>	30°C	☼ - 30°C	-	1,0	**	-	✓	-	-	-	✓	✓	-	-	-	-
• <b>Pets Stuff</b>	40°C	☼ - 40°C	600	2,0	**	-	✓	-	✓	✓	-	✓	-	-	-	-
• <b>Multi Color</b>	20°C	☼ - 20°C	1400	10,0	**	-	✓	-	✓	✓	-	✓	-	-	-	-
• <b>Anti Stain</b>	40°C	☼ - 40°C	1400	10,0	**	-	✓	-	✓	✓	✓	✓	-	-	-	-
<b>Eco 40-60 (1)</b>	40°C	40°C	1351	10,0	3:59	-	✓	-	-	-	✓	✓	53	0,800	60	29
			1351	5,0	2:55	-	✓	-	-	-	✓	✓	53	0,530	45	28
			1351	2,5	2:30	-	✓	-	-	-	✓	✓	53	0,310	35	22
<b>Full Load 45'</b>	40°C	☼ - 40°C	1200	10,0	**	✓	✓	-	✓	✓	✓	✓	-	-	-	-
<b>Rapid 30'</b>	30°C	☼ - 30°C	800	5,5	0:30	-	✓	-	✓	✓	-	✓	67	0,167	42	28
<b>Steam Refresh 20'</b>	-	-	-	2,0	**	-	-	-	-	-	-	-	-	-	-	-

! Selecting "More cycles" on the control dial gives you access to extra wash cycles shown in the table above.

The cycle duration indicated on the display or instruction manual is an estimate based on standard conditions. The actual duration may vary in relation to several factors, such as the temperature and pressure of the incoming water, ambient temperature, amount of detergent, load quantity and type, load balancing and any additional options selected. The values given for programmes other than the Eco 40-60 programme are indicative only.

1) Eco 40-60 - Test wash cycle in compliance with EU Ecodesign regulation 2019/2014. The most efficient programme in terms of energy and water consumption for washing normally soiled cotton laundry.

On this cycle the Autodose system is disabled and is recommended to use powder detergent in the manual dosing department.

Note: spin speed values shown on the display can slightly differs from the values stated in the table.

For all testing institutes:

2) Long cotton cycle: set wash cycle "Cotton" with a temperature of 40°C.

3) Long synthetics cycle: set wash cycle "Synthetics" with a temperature of 40°C.

\* By selecting the "Spin & Drain" cycle and excluding the spin cycle, the washing machine will drain only.

\*\* The duration of the wash cycles can be checked on the display.

\*\*\* After programme end and spinning with maximum selectable spin speed, in default programme setting.

6th Sense - the sensor technology adapts water, energy and programme duration to your wash load.

## PRODUCT DESCRIPTION

1. Top
2. Detergent dispenser drawer
3. Control panel
4. Handle
5. Porthole door
6. Pump Filter / Emergency drain hose (behind cover flap)
7. Adjustable feet (4)

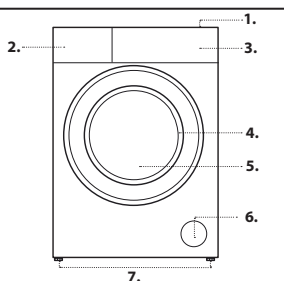

## DETERGENT DISPENSER DRAWER

Handle the dispenser with care. Avoid pulling or pushing hard the dispenser during opening and closing.

### AUTOMATIC DOSING:

IMPORTANT: Only use liquid detergent to fill the detergent tanks ("1" and "2"); never use powder detergent

#### 1. Tank 1

- Liquid generic detergent OR
- Liquid specific detergent (e.g. for colours, wool, sports garments etc.)

IMPORTANT: Never fill Fabric Softener in Tank Maximum filling quantity: 800 ml

#### 2. Tank 2

- Fabric softener

IMPORTANT: Fabric softener could be used only with automatic dosing. Maximum filling quantity: 400 ml

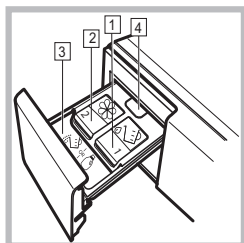

Choose your preferred configuration among those mentioned in section AUTO DOSING

### MANUAL DOSING:

#### 3. Detergent compartment for manual dosing

- Powder or liquid detergent
- Additives

If you use powder detergent, make sure to fill the compartment only up to the "max" mark.

#### 4. Release button

Press down to remove the detergent dispenser for cleaning.

When the warning "It's recommended to clean the detergent drawer. Follow the use and care guide" is shown on the display, we recommend cleaning the detergent drawer, following detailed instructions can be found in the 'Care and Maintenance' section.

If the message appears while the detergent and fabric softener dispensers are still full, ensure all detergent is used before cleaning the detergent dispenser.

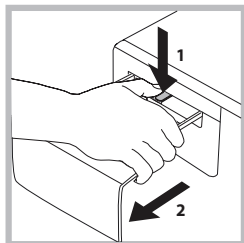

## WASH CYCLES

Follow the instructions on the symbols of the garment's wash care label. The value indicated in the symbol is the maximum recommended temperature for washing the garment. Optimal washing results are obtained by respecting the maximum load kg shown in the cycle table.



### Mixed Extra Silence

Discover the silence: this programme runs silently for the entire cycle, spin phase included, staying always below 60db. The characteristics and the duration of the cycle make it perfect for being run at night. It is designed for a half load and mixed fibers (cotton & synthetics), with the spin speed adjusted for a more delicate clean. After the cycle, FreshCare+ option will start automatically, for 100% freshness and total peace of mind.

### Mixed

For washing lightly to normally soiled resilient garments in cotton, linen, synthetic fibres and mixed fibres.

### Synthetics

Suitable for washing moderately soiled garments made of synthetic fibres (e.g. polyester, polyacrylic, viscose, etc.) or mixed synthetic-cotton fibres.

### Cotton

Normally to heavily soiled and robust cottons.

### Delicates

For washing very delicate garments. It is advisable to turn the garments inside out before washing them. For best results, use liquid detergent on delicate garments.

### 20°C

For washing lightly soiled cotton garments, at a temperature of 20 °C.

### Wool

All wool garments can be washed using programme, "Wool" even those carrying the "hand-wash only" label. For best results, use special detergents and do not exceed max kg declaration of laundry.

### Spin & Drain

Spins the load then empties the water. For resilient garments. If you exclude the spin cycle, the machine will drain only.

### Rinse & Spin

Rinses and then spins. For resilient garments.

### Anti Allergy

Suitable for removing major allergens such as pollen, mites and cat or dog hair, thanks to a high-temperature technology and extra rinses.

! This cycle is working at 60°C temperature for at least 30 minutes.

### More Cycles

#### Shirts

Use the special wash cycle to wash shirts in different fabrics and colours to guarantee they receive the best possible care.

#### Jeans

Turn garments inside-out before washing and use a liquid detergent.

#### Bed & Bath

For washing bed linen and towels in a single cycle. It optimises the use of fabric softener and allows for saving time and electricity. We recommend the use of powder detergent.

#### Duvet

Designed for washing eiderdown padded items such as double or single duvets, cushions and anoraks. It is recommended to load such padded items in the drum with the edges folded inwards and not to exceed ¾ of the drum's volume. For optimal washing, we recommend using a liquid detergent.

#### Silk & Curtains

Use the special wash cycle to wash all silk garments or curtains. We recommend the use of special detergent which has been designed to wash delicate clothes.

For washing curtains, fold and place them in a pillow case or mesh bag.

#### Baby

Use the special wash cycle to remove the soiling typically caused by babies, while removing all traces of detergent from nappies in order to prevent the delicate skin of babies from suffering allergic reactions. The cycle has been designed to reduce the amount of bacteria by using a greater quantity of water and optimising the effect of special disinfecting additives added to the detergent.

#### Cuddly toys

Specific programme for removing dust and washing cuddly toys.

#### Pets Stuff

Perfect for removing animal hair from pets bedding and items.

#### Multi Color

This cycle is suitable for washing multi-coloured items, or various different colours together. The programme is studied to guarantee colour care, working at 20°C with the same performance as 40°C. It is suggested to use a detergent for coloured clothes and for low temperatures.

! It's always suggested to separate clothes that are faded and new coloured clothes, being washed for the first time.

#### Anti Stain

The programme is suitable to heavily-soiled garments with resistant colours. It ensures a washing class that is higher than the standard class. When running the programme, do not mix garments of different colours. We recommend the use of powder detergent. Pre-treatment with special additives is recommended if there are obstinate stains.

### Eco 40-60

For washing normally soiled cotton garments declared to be washable at 40 °C or 60 °C, together in the same cycle. This is the standard cotton programme and the most efficient in terms of water and energy consumption. It is a normative programme that can be set up only at 40 °C.

### Full Load 45'

Suitable for washing a full load of cotton clothes moderately soiled in 45 minutes.

### Rapid 30'

For washing lightly soiled garments quickly. This cycle lasts only 30 minutes, saving time and energy.

### Steam Refresh 20'

The garments will be damp once the cycle is completed, so we recommend hanging them to dry (2 kg, roughly 3 items). This programme refreshes garments by removing bad odours and relaxing the fibres. Insert dry items only (that are not dirty) and select programme "Steam Refresh 20' ". The "Steam Refresh 20' " programme makes ironing easier.

! Do not add softeners or detergents.

! Not recommended for wool or silk garments.

## DISPLAY

The display is useful when programming the washing machine and provides plenty of information.

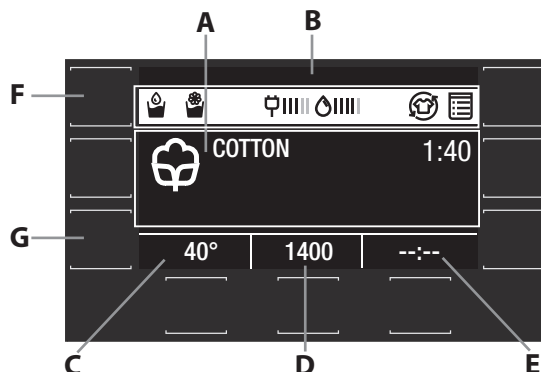

By pressing the and buttons, it is possible to select the desired option and confirm it with the button.

The first time the machine is switched on, you will be asked to select the language and the display will automatically display the language selection menu.

To select the desired language, press the and buttons; to confirm the selection, press the button.

Area **A** will display the following: the icon and selected washing programme, the washing phases and the time remaining to the end of the wash cycle.

Area **B** will display the AutoDose status: the selected options, the energy and water consumption for the chosen cycle and the button lock symbol.

Area **C** will display the default temperature value on the basis of the set programme; if the programme does not include the setting of the temperature, the area will display the "-- °" symbol.

Area **D** will display the default spin cycle speed on the basis of the set programme; if the programme does not include the setting of the spin cycle, the area will display the "--" symbol.

Area **E** will display the time remaining to the start of the selected programme if the DELAYED START function was set.

Pressing button **F** allows for accessing the menu from which to set Auto Dosing option.

Pressing button **G** allows for accessing the menu from which to set additional washing options.

Pressing and holding button **G** for 3 seconds allows for accessing the settings menu:

- Language: by pressing the and buttons, the user can select the desired language and confirm it with the button.

- Sound: by pressing the and buttons, the user can activate or deactivate the sound of the buttons and confirm it with the button.

- Display brightness: by pressing the and buttons, the user can select the type of display brightness and confirm it with the button.

- Autodose: By pressing the buttons and the user can choose from three different levels of detergent usage. For more details see section "AUTODOSE SET-UP" Only for AUTODOSE it is possible to carry out the setup using the dedicated option button.

- Restoring the factory settings: pressing and holding the button for 2 seconds restores the factory settings.

#### DISPLAY INDICATORS

Failure: Call Service

Refer to Troubleshooting section

Failure: Drain pump filter clogged

Water cannot be drained; drain pump filter might be blocked

Failure: No water

No or not sufficient inlet water.

In the event of any failure, refer to the "Troubleshooting" section.

#### Key Lock

To activate the control panel lock, press and hold the button for roughly 3 seconds. When the display visualises "KEY LOCK", the control panel is locked (except for the ON/OFF button ). This will prevent accidental modifications to wash cycles, especially when children are at home. To deactivate the control panel lock, press and hold the button for approximately 3 seconds.

#### Locked door indicator

When lit, the symbol indicates that the door is locked. To prevent any damage, wait until the symbol turns off before opening the door.

To open the door while a cycle is in progress, press the START/PAUSE button ; if the symbol is off, the door can be opened.

### FIRST-TIME USE

Once the appliance has been installed, and before you use it for the first time, run a wash cycle with a small amount of detergent and no laundry, using the wash cycle **Cotton** (60°) without option Prewash selected.

### DAILY USE

Prepare the laundry by following the suggestions appearing under the "TIPS AND SUGGESTIONS" section.

- Press the ON/OFF button ; "WHIRLPOOL" will appear on the display.

- Open the door. Load the laundry while making sure not to exceed the maximum load quantity indicated in the wash cycle table.

- Push to open the detergent dispenser drawer and pour the detergent into the relevant compartments, as described in the "DETERGENT DISPENSER DRAWER" section.

- Close the door.

- Select the desired wash cycle.

- Select the desired options.

- The machine automatically selects the default temperature and spin speed set for the selected wash cycle.

- Press the START/PAUSE button to start the wash cycle; the door will lock ( symbol on). Once the cycle starts, the Sensing routine will begin: the drum will move and then door will be unlocked and locked again to start properly the washing cycle.

### PAUSING A CYCLE

To pause the wash cycle, press the START/PAUSE button again. To start the wash cycle from the point at which it was interrupted, press the START/PAUSE button again.

### OPENING THE DOOR, IF NECESSARY

Once a cycle starts, the symbol turns on to signal that the door cannot be opened. While a wash cycle is running, the door remains locked. To open the door while a cycle is under way, for example, to add or remove garments, press the START/PAUSE button to pause the cycle. If the symbol is not lit, the door may be opened. Press the START/PAUSE button again to continue the cycle. Once the cycle starts, the Sensing

routine will begin: the drum will move and then door will be unlocked and locked again to start properly the washing cycle.

### STOP&ADD

An icon on the display will signal when additional garments can be introduced into the washing machine, without decreasing the washing performance. To add garments, first stop the washing machine by pressing the START/PAUSE button then open the door and insert them.

Press the START/PAUSE button again to restart the wash cycle from the point at which it was interrupted.

### CHANGING A RUNNING WASH CYCLE

To change a wash cycle while it is in progress, pause the washing machine using the START/PAUSE button, then select the desired cycle and press the START/PAUSE button again.

! To cancel a cycle that has already begun, press and hold for a few seconds the ON/OFF button. If water is present then drain function will start. The cycle will be stopped and the machine will switch off.

### AT THE END OF THE WASH CYCLE

This will be indicated by the word "CYCLE END" on the display; when the symbol switches off, the door may be opened. Open the door, unload the laundry and switch off the machine. If you do not press ON/OFF button, the washing machine will switch off automatically after about 10 minutes.

### OPTIONS

- If the selected option is incompatible with the set wash cycle or with another previously selected option, in the menu the name of incompatible option is represented in grey color and the wording "Not available" will appear on the display, accompanied by a buzzer, the option will not be activated.

#### AutoDose

The automatic dosing system will intake the amount of liquid detergent accordingly to the selected level and selected program, and it will adjust it also to the load detected, while for the softener the system is automatically adjusting in according to selected program and automatic load detected. The automatic dosing system has been activated at the factory for all the designated programmes and can be deactivated for each one individually. In order to use intelligent dosing, fill the dispenser.

Note:

- Fill the dispenser only with suitable detergent and care products

- If you change the liquid detergent or fabric softener, empty and clean the dispenser beforehand.

- Pour liquid detergent (Detergent) and fabric softener (Softener) into the relevant dispensers every time the related icon is showing empty level.

#### Autodose Set-up

- Switch the washing machine ON.

- **By default the Autodose feature is activated; for some cycles the autodose cannot be enabled according to the wash cycle table.**

- The display will show a message if the drawer is empty.

- **In this case**, pull out the detergent dispenser drawer and fill it with detergent/softener into the relative AUTODOSE compartment. Close the drawer.

- Switch the washing machine OFF

- Switch the washing machine ON again. Now the symbols shown on the upper left side of the display ( ) indicate the machine is loaded with detergent and/or softener.

- Press and hold the AUTODOSE button () for 3 seconds.

The following modes are available:

- Detergent tank (Enable\Disable)

- Detergent status (Full\Empty)

- Detergent concentration

- Softener tank (Enable\Disable)

- Softener status (Full\Empty)

- Reset auto dose value

- Select the DETERGENT TANK and/or the SOFTENER TANK option according to your needs and press OK.

- Select ENABLED/DISABLED and press OK

- Select the DETERGENT CONCENTRATION option and choose it according to your preferred detergent specifications and press OK (Only for DETERGENT TANK option).

By default, the system will use a dose of 25ml of detergent for each cycle. Select 25ml for highly concentrated detergent as recommended dosing value on detergent package for medium loads of 4Kg-5Kg is <30ml.

Select 35ml for medium concentrated detergent as recommended dosing value on detergent package for medium loads of 4Kg-5Kg is 30-40ml.

Select 45ml for low concentrated detergent as recommended dosing value on detergent package for medium loads of 4Kg-5Kg is >40ml.

Ensure you adjust the preset dosing value to the correct level, corresponding to the recommended values indicated on the detergent package that you intend to use, considering a medium load (4Kg-5Kg).

This option is not valid for adjustment of softener concentration.

- Select a washing programme with the selector dial.

- Press the AUTODOSE button () once, two or three times (see WASH CYCLE TABLE) to select the following modes available:

- Detergent and Softener

- Detergent Only

- Softener Only

- Manual Dosing (**Both detergent and softener disabled**)

- Start washing cycle

NOTE: for each cycle the last selected user configuration is saved. It is possible to come back to the original setting by selecting "Return to the default values" chosen in the pick list of the \AUTODOSE menu.

NOTE: Press and hold the AUTODOSE button (⏸) for 3 seconds and select the DETERGENT STATUS or SOFTENER STATUS for checking if the tanks are loaded.

NOTE: It is recommended to clean the drawer before refilling it again.

#### 🌀 Steam Hygiene

This option enhances washing performance by generating steam during the wash cycle to remove any bacteria from the fibres, which are treated at the same time. Place the laundry in the drum, choose a compatible programme and select option Steam Hygiene.

! The steam generated during the operation of the washing machine may cause the porthole door to become hazy.

#### 💧 WaterSave

The new WaterSave Technology is designed to protect your garments while ensuring extraordinary savings of water. When WaterSave is turned on, a stream of water is released from the top of the drum and distributes through your garments evenly: the result is a thorough wash even at low temperatures, to always wash your clothes only using the right amount of water.

#### ⌚ Start Delay

To set a delayed start for the selected cycle, press the corresponding button repeatedly until the desired delay period is reached. When this option has been activated, the selected values of delay start will appear on the display. To remove the delayed start setting, press the button until "--:--" appears on the display.

#### 🧺 Easy Iron

By selecting this function, the wash and the spin cycles will be modified in order to reduce the formation of creases.

#### 🌿 FreshCare+

This option is designed to keep your garments fresh up to 6 hours after the cycle is over. The Innovative FreshCare+ system takes care of your garments inside the washing machine with a delicate steaming and tumbling action. FreshCare+ system gently massages the laundry with regular slow movements alternated with steam actions - letting air circulate inside the fibers to keep garments fresh and prevent bad odours. FreshCare+ treatment leaves truly fresher clothes and peace of mind - even hours after the end of the cycle. FreshCare+ treatment inhibits the proliferation of the main bad odours sources (inside the washing machine) up to 6 hours after the washing ends.

This option, when activated, will start the tumbling at the end of the washing cycle for up to 6 hours: at any moment, putting in OFF the machine, the door can be opened and the cycle will stop. When steam action is ongoing, a bit of time will need to be waited before the door unlocks for opening.

#### ⚡ Rapid

Select this option to reduce the cycle time. This cycle is suggested for washing light soiled clothes.

#### 🔄 Multi Rinse

By selecting this option, the efficiency of the rinse is increased and optimal detergent removal is guaranteed. It is particularly useful for sensitive skin. Press the button once, two or three times to select an additional 1, 2 or 3 rinses after the standard cycle rinse and remove all traces of detergent. Press the button again to go back to the "Normal rinse" rinse type.

#### ❄️ Cold Wash

This option saves energy by not heating the water used to wash your laundry - an advantage both to the environment and to your energy bill. Instead, intensified wash action and water optimisation ensure great wash results in the same average time of a standard cycle.

For the best washing results we recommend the usage of a liquid detergent.

#### 🧼 Prewash

If the Prewash option is selected, it is important to put the detergent in the compartment dedicated to the manual dose. The Autodose option must be active to carry out the washing phase.

#### 🌡️ Temperature

Each wash cycle has a pre-defined temperature. To modify the temperature, press the "🌡️" button. All values available, for each cycle, will appear on the display.

#### 🌀 Spin

Each wash cycle has a pre-defined spin speed. To modify the spin speed, press the "🌀" button. All values available, for each cycle, will appear on the display.

## DESCALE AND CLEAN PROCEDURE

An icon (🧼) on the display will regularly (roughly every 50 cycles) remind users that it is time to run a maintenance cycle to clean the washing machine and combat limescale build-up and bad odours.

For optimal maintenance we suggest to run empty cycle "Cotton" at minimum 60°C without PreWash and using WPRO Limescale and grease remover.

The product can be purchased by contacting the technical assistance service or through the website [www.whirlpool.eu](http://www.whirlpool.eu).

Whirlpool declines all liability for any damages to the appliance caused by the use of other cleaning products for washing machines available on the market. To delete the descale alert turn the knob or push any button (including ON/OFF button).

## TIPS AND SUGGESTIONS

### Divide the laundry according to:

Type of fabric (cotton, mixed fibres, synthetics, wool, garments to be hand-washed). Colour (separate coloured garments from whites, wash new coloured garments separately). Delicates (small garments - such as nylon stockings - and items with hooks - such as bras: insert them in a fabric bag).

### Empty the pockets:

Objects such as coins or lighters can damage the washing machine and the drum. Check all buttons.

### Follow the dosage recommendation / additives

It optimizes the cleaning result, it avoids irritating residues of surplus detergent in your laundry and it saves money by avoiding waste of surplus detergent

### Use low temperature and longer duration

The most efficient programmes in terms of energy consumption are generally those that perform at lower temperatures and longer duration.

### Observe the load sizes

Load your washing machine up to the capacity indicated in the "PROGRAMME CHART" table to save water and energy.

### Noise and remaining moisture content

They are influenced by the spinning speed: the higher the spinning speed in the spinning phase, the higher the noise and the lower the remaining moisture content.

## CARE AND MAINTENANCE

*Before performing cleaning and maintenance, switch the washing machine off and disconnect it from the mains power. Do not use flammable liquids to clean the washing machine. Clean and maintain your washing machine periodically (at least 4 times per year).*

### Disconnect the water and power supplies

Close the water tap after every wash. This will limit wear on the hydraulic system inside the washing machine and help to prevent leaks.

Unplug the washing machine when cleaning it and during all maintenance work.

### Clean the washing machine

The outer parts and rubber components of the appliance can be cleaned using a soft cloth soaked in lukewarm soapy water. Do not use solvents or abrasives.

### Clean the detergent dispenser drawer

Remove the detergent drawer as indicated in the DETERGENT DISPENSER DRAWER paragraph, wash it under running water, also running water in the detergent and softener tanks, this operation should be repeated frequently.

### Care for the door and drum

Always leave the porthole door ajar in order to prevent unpleasant odours from forming.

### Check the water inlet hose

Check the water inlet hose at least once a year. If it is cracked or broken, it must be replaced: during wash cycles, the high pressure of the water could suddenly split the hose open.

! Never use hoses that have already been used.

### Cleaning the drain pump filter / draining residual water

*Switch off and unplug the washing machine; before cleaning the drain pump filter or draining residual water.*

*If you used a hot wash programme, wait until the water has cooled down before draining any water. Clean the drain pump filter regularly, to avoid that the water cannot drain after the wash due to obstruction of the filter. If the water cannot drain, the display indicates that the drain pump filter may be clogged.*

1. Power Off and unplug the washing machine from the electrical outlet.
2. Gently press the top area of the filter cover to open.

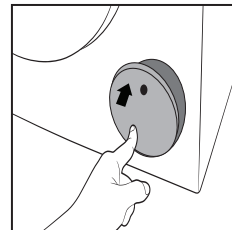

3. Place a container close to the pump to collect any spillage.
4. Stretch the "emergency drain hose" to the container.

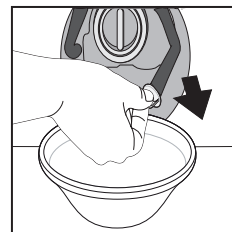

5. Turn the stopper of the "emergency drain hose" at the end of the hose and let the water flow into the container.

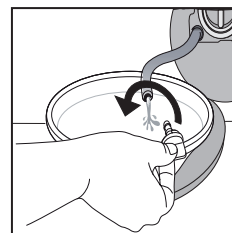

6 . When the container is full with water, plug the stopper to the hose end, and reinsert the small hose in the washing machine's base . After, empty the container . Afterwards firmly close the emergency drain hose with the stopper .

7. **Remove filter:** Lay a cotton cloth beneath the drain pump filter, which can absorb a small amount of water . Then remove the drain pump filter by turning it out anticlockwise .

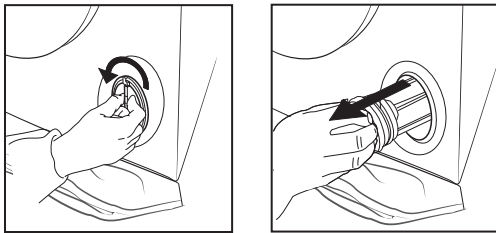

8 . Clean the drain pump filter: remove residues in the filter and clean it under running water .

Check that there are no foreign bodies in the filter housing (coins, buttons, color-catching strips...) that would prevent the rotation of the pump fan.

9 . Insert the drain pump filter: Reinsert the drain pump filter again by turning it in clockwise direction . Make sure to turn it in as far as it goes; the filter handle must be in vertical position .

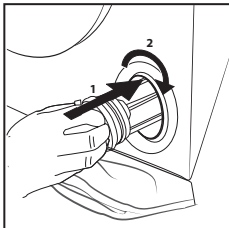

## ACCESSORIES

---

Contact our Technical Assistance Service to check whether the following accessories are available for this washing machine model.

### **Stacking kit**

With this accessory you can secure the tumble dryer to the upper part of your washing machine to save space and facilitate loading and unloading of the tumble dryer.

## TRANSPORT AND HANDLING





---

*Do not lift the washing machine by gripping it from the upper section.*

Unplug the appliance and close the water tap. Check that the door and detergent dispenser drawer are tightly closed. Detach the filling hose from the water tap then detach the drain hose. Empty all the water remaining in the hoses and secure the latter so that they do not get damaged during transport. Apply the transport bolts back on. Repeat, in reverse order, the transport bolt removal procedure described in the "Installation instructions".

## TROUBLESHOOTING

Your washing machine could occasionally fail to work. Before contacting the Technical Assistance Service, make sure that the problem cannot be easily solved using the following list.

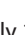
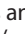
Anomalies	Possible causes / Solution
<b>The washing machine does not start.</b>	The appliance is not plugged into the socket fully, or not enough to make contact.
	There is no power in the house.
<b>The wash cycle does not start.</b>	The washing machine door is not closed properly.
	The ON/OFF  button has not been pressed.
	The START/PAUSE  button has not been pressed.
	The water tap has not been opened.
	A delay has been set for the start time.
	The Demo Mode is active (see below how to deactivate).
<b>The washing machine does not fill with water ("S" appears on the display).</b>	The water inlet hose is not connected to the tap.
	The hose is bent.
	The water tap has not been opened.
	There is no water supply in the house.
	The pressure is too low.
	The START/PAUSE  button has not been pressed.
<b>The washing machine continuously loads and unloads water.</b>	The drain hose is not fitted between 65 and 100 cm from the floor.
	The free end of the hose is immersed in water.
	The wall drainage system is not fitted with a breather pipe.
	If the problem persists even after these checks, turn off the water tap, switch the appliance off and contact the Technical Assistance Service. If the home is on one of the upper floors of a building, there may be problems relating to back-siphonage, causing the washing machine to fill with water and drain continuously. Special anti-siphon valves are available in shops and help to prevent this inconvenience.
<b>The washing machines does not drain and the symbol  (F9E1) on the display.</b>	Clean the pump filter (see Care and maintenance chapter)
	The drain hose is bent.
	The drainage duct is clogged.
<b>The washing machine vibrates a lot during the spin cycle.</b>	Transport bolts have been not removed correctly during installation.
	The washing machine is not leveled.
	The washing machine is tucked between furniture cabinets and the wall.
<b>The washing machine leaks.</b>	The water inlet hose is not screwed on properly.
	The detergent dispenser drawer is obstructed.
	The drain hose is not properly attached.
<b>The  symbol appear and the display visualises an error code (e.g.: F1E1, F4...).</b>	Switch off the machine and unplug it, wait for approximately 1 minute and then switch it back on again. If the problem persists, contact the Technical Assistance Service.
<b>There is too much foam.</b>	The detergent is not suitable for machine washing (it should display the text "for washing machines" or "hand and machine wash", or the like).
	Too much detergent was used.
<b>"" phase icon blinks, "0" spin speed displayed .</b>	Unbalance of laundry load prevented spin cycle, to protect the washing machine. If you want to spin the wet laundry, add more laundry items of different sizes and start "Spin&Drain" programme. Avoid small laundry loads consisting of few big, absorbent pieces of laundry / wash different sizes of articles in one load.

*Disable the DEMO MODE : The following actions must be carried out in sequence, without breaks. Switch the machine ON and then switch it OFF again. Press the START/PAUSE  button until the buzzer is heard. Switch the machine on again. The "DEMO" indicator flashes and then turns OFF.*



You can download the **H&S INSTRUCTIONS, PRODUCT FICHE and ENERGY DATA** by:

- Visiting our website - <http://docs.whirlpool.eu>
- Using QR code
- Alternatively, **contact our After-sales Service** (See phone number in the warranty booklet). When contacting our After-sales Service, please state the codes provided on your product's identification plate.

For User's Repair & Maintenance Information visit [www.whirlpool.eu](http://www.whirlpool.eu)

The model information can be retrieved using the QR-Code reported in the energy label. The label also includes the model identifier that can be used to consult the portal of the registry at <https://eprel.ec.europa.eu>

