

# **INSTRUCTIONS FOR USE**

**BEFORE USING THE APPLIANCE**

**SAFEGUARDING THE ENVIRONMENT**

**PRECAUTIONS AND GENERAL  
RECOMMENDATIONS**

**HOW TO USE THE REFRIGERATOR  
COMPARTMENT**

**HOW TO USE THE LOW TEMPERATURE  
COMPARTMENT WHEN PRESENT**

**HOW TO DEFROST AND CLEAN THE LOW  
TEMPERATURE COMPARTMENT**

**HOW TO CLEAN THE REFRIGERATOR  
COMPARTMENT**

**CLEANING AND MAINTENANCE**

**ENERGY SAVING TIPS**

**TROUBLESHOOTING GUIDE**

**AFTER-SALES SERVICE**

**INSTALLATION AND DOOR REVERSIBILITY**

**ELECTRICAL CONNECTION**

## BEFORE USING THE APPLIANCE

- Your new appliance is designed exclusively for domestic use.

**To ensure best use of your appliance, carefully read the operating instructions which contain a description of the product and useful advice.**

**Keep these instructions for future reference.**

1. After unpacking the appliance, make sure it is not damaged and that the door closes properly. Any damage must be reported to the dealer within 24 hours of delivery of the appliance.
2. Wait at least two hours before switching the appliance on, to ensure that the refrigerant circuit is fully efficient.
3. Installation and electrical connection must be carried out by a qualified technician according to the manufacturer's instructions and in compliance with local safety regulations.
4. Clean the inside of the appliance before using it.

## SAFEGUARDING THE ENVIRONMENT

### 1. Packaging

The packing material is 100% recyclable and bears the recycling symbol. For disposal, comply with the local regulations. Keep the packing materials (plastic bags, polystyrene parts, etc.) out of the reach of children, as they are a potential source of danger.

### 2. Scrapping/Disposal

The appliance is manufactured using recyclable material.

This appliance is marked in compliance with European Directive 2002/96/EC on Waste Electrical and Electronic Equipment (WEEE). By ensuring the correct disposal of this appliance, you can help prevent potentially negative consequences for the environment and human health.

The symbol  on the appliance, or on the accompanying documents, indicates that this appliance should not be treated as domestic waste but must be taken to a special collection centre for the recycling of electrical and electronic equipment.

When scrapping the appliance, make it unusable by cutting off the power cable and removing the doors and shelves so that children cannot easily climb inside and become trapped.

Scrap the appliance in compliance with local regulations on waste disposal, taking it to a special collection centre; do not leave the appliance unattended even for a few days, since it is a potential source of danger for children. For further information on the treatment, recovery and recycling of this product, contact your competent local office, the household waste collection service or the shop where you purchased the appliance.

### Information:

This appliance does not contain CFCs.

The refrigerant circuit contains R134a (HFC) or R600a (HC) (see the rating plate inside the appliance).

Appliances with Isobutane (R600a): isobutane is a natural gas without environmental impact, but is flammable. Therefore, make sure the refrigerant circuit pipes are not damaged.

This product may contain Fluorinated Greenhouse Gases covered by the Kyoto Protocol; the refrigerant gas is inside a hermetically sealed system.

Refrigerant gas: R134a has a Global Warming Potential of (GWP) 1300.

### Declaration of conformity

This appliance has been designed for preserving food and is manufactured in compliance with Regulation (CE) No. 1935/2004.



This appliance has been designed, manufactured and sold in compliance with:

- safety objectives of the "Low Voltage" Directive 2006/95/CE (which replaces 73/23/CEE and subsequent amendments);
- the protection requirements of Directive "EMC" 2004/108/CE.

Electrical safety of the appliance can only be guaranteed if it is correctly connected to an approved earthing system.



## PRECAUTIONS AND GENERAL RECOMMENDATIONS

### INSTALLATION

- The appliance must be handled and installed by two or more persons.
- Be careful not to damage the floors (e.g. parquet) when moving the appliance.
- During installation, make sure the appliance does not damage the power cable.
- Make sure the appliance is not near a heat source.
- To guarantee adequate ventilation, leave a space on both sides and above the appliance and follow the installation instructions.
- Keep the appliance air vents unobstructed.
- Do not damage the appliance refrigerant circuit pipes.
- Install and level the appliance on a floor strong enough to take its weight and in a place suitable for its size and use.
- Install the appliance in a dry, well ventilated place. The appliance is arranged for operation in places where the temperature comes within the following ranges, according to the climatic class given on the rating plate. The appliance may not work properly if left for a prolonged period of time at a temperature outside the specified range.

Climatic Class	Amb. temp. (°C)	Amb. temp. (°F)
SN	From 10 to 32	From 50 to 90
N	From 16 to 32	From 61 to 90
ST	From 16 to 38	From 61 to 100
T	From 16 to 43	From 61 to 110

- Make sure the voltage specified on the rating plate corresponds to that of your home.
- Do not use single/multi adapters or extension cables.
- For the water connection, use the pipe supplied with the new appliance; do not reuse that of the previous appliance.
- Power cable modification or replacement must only be carried out by qualified personnel.
- It must be possible to disconnect the appliance from the power supply by unplugging it or by means of a two-pole switch fitted upline of the socket.

### SAFETY

- Do not store or use petrol, flammable liquids or gas in the vicinity of this or other electrical appliances. The fumes can cause fires or explosions.
- Do not use mechanical, electric or chemical means other than those recommended by the Manufacturer to speed up the defrosting process.
- Do not use or place electrical devices inside the appliance compartments unless such appliances are specifically recommended by the manufacturer.
- This appliance is not intended for use by persons (including children) with reduced physical, sensory or mental capabilities or lack of experience and knowledge of the appliance, unless they have been given supervision or instruction concerning use of the appliance by a person responsible for their safety.
- To avoid the risk of children becoming trapped and suffocating, do not allow them to play or hide inside the appliance.
- Do not swallow the contents (non-toxic) of the ice packs (in some models).
- Do not eat ice cubes or ice lollies immediately after taking them out of the freezer since they may cause cold burns.

### USE

- Before carrying out any maintenance or cleaning operation, unplug the appliance or disconnect it from the power supply.
- All appliances equipped with an automatic icemaker and water dispenser must be connected to a mains water supply that delivers potable water only (with mains water pressure of between 0.17 and 0.81 Mpa (1.7 and 8.1 bar)). Automatic ice-makers and/or water dispensers not directly connected to the water supply must be filled with drinking water only.
- Use the refrigerator compartment only for storing fresh food and the freezer compartment only for storing frozen food, freezing fresh food and making ice cubes.
- Do not store glass containers with liquids in the freezer since they may burst.

**The Manufacturer declines any liability if the above advice and precautions are not respected.**

# HOW TO USE THE REFRIGERATOR COMPARTMENT

This is an automatic refrigerator or refrigerator with  star low temperature compartment.

**Refrigerator compartment defrosting is fully automatic.**

The refrigerator operates in an ambient temperature ranging from +16°C to +32°C.

## Switching on the refrigerator

Insert the plug in the mains socket. The thermostat allows you to set the temperature inside the refrigerator compartment without altering the conditions inside the low temperature compartment.

## Setting the temperature:

1. For correct operation and excellent storage results in both compartments, set the thermostat between positions 2 and 3.
2. To set the temperature inside the compartments, turn the thermostat as follows:
  - 2 - 3 for a **WARMER TEMPERATURE.**
  - 3 - 4 for a **COLDER TEMPERATURE.**

Thermostat set to 0: position: the appliance and lighting switch off.

## Note:

Ambient temperature, the frequency with which the doors are opened and closed and the position of the appliance can affect the temperature inside the two compartments. Adjust the thermostat accordingly.

## How to store food in the refrigerator compartment

- I. Store the food as shown in the adjacent illustration.

- A Cooked food
- B Fish and meat
- C Fruit and vegetables
- D Bottles
- E Eggs
- F Butter, cheese and other dairy products

## Notes:

- Make sure the air circulates freely between the shelves and the back wall of the refrigerator.
- Do not store food against the back wall of the compartment.
- Store liquids in sealed containers.
- Vegetables with a high water content (e.g. lettuce) may cause condensation to form in the bottom drawers and/or on the middle shelves; this does not affect the correct operation of the appliance. Nevertheless, it is advisable to wrap vegetables before storing.

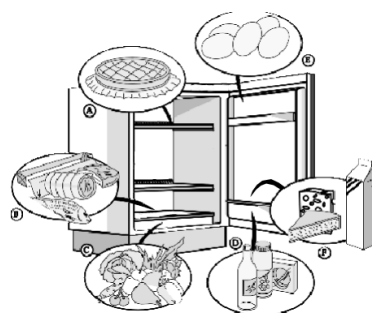
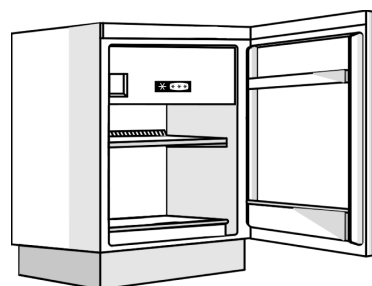
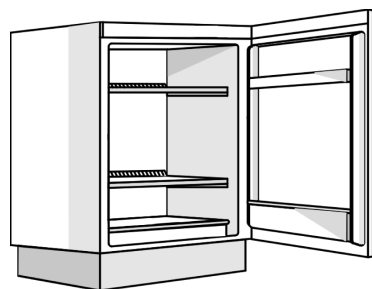

## HOW TO USE THE LOW TEMPERATURE COMPARTMENT WHEN PRESENT

If installed, the  star low temperature compartment may be used to store frozen products for the time indicated on the packaging.

**When purchasing deep-frozen foods, check the following:**

- That the packaging is intact, since the food may have deteriorated. If the package bulges or is marked by damp patches, the product has not been correctly stored and may have partially thawed.
- Purchase deep-frozen foods last and use insulated bags for transportation.
- Place items in the low temperature compartment as soon as you get home.
- Consume partially thawed food within 24 hrs.
- Avoid temperature variations as much as possible. Observe the "best before" date on the packaging.
- Observe the instructions for preserving deep-frozen foods written on the packaging.

### How to make ice-cubes

- Fill the ice-tray 3/4 full of water and place it in the bottom of the low temperature compartment.
- If the ice-tray sticks to the bottom, **do not use pointed or sharp instruments to detach it.**

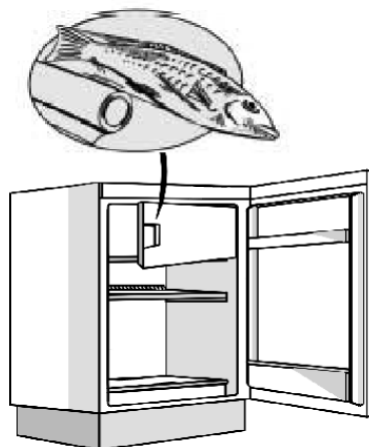

## HOW TO DEFROST AND CLEAN THE LOW TEMPERATURE COMPARTMENT

**To maximise performance, defrost the low temperature compartment at least twice a year, or when the layer of ice on the walls reaches 3 mm thickness.**

**Defrost the compartment when the contents are low.**

1. Open the door and take out all food items, wrapping them in newspaper and placing them together in a cool place or in an insulated bag.
2. Unplug the appliance from the mains.
3. Leave the door open to allow the frost/ice on the compartment walls to melt.
4. Remove the defrost water with a sponge.
5. Clean with a sponge soaked in a solution of lukewarm water and neutral detergent. **Do not use abrasive substances.**
6. Rinse and dry thoroughly.

**Note: to avoid causing irreparable damage, do not use pointed or sharp metal instruments to scrape off ice and do not artificially heat the low temperature compartment.**

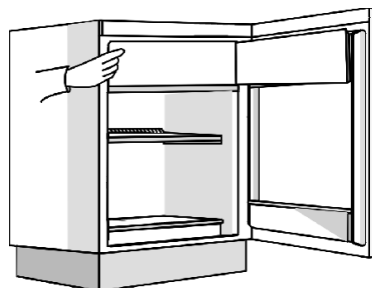

## HOW TO CLEAN THE REFRIGERATOR COMPARTMENT

**Clean the refrigerator compartment regularly.**

**Refrigerator compartment defrosting is fully automatic.**

The formation of water droplets on the rear internal wall of the refrigerator compartment indicates that the automatic defrosting is underway. Defrost water is channelled to a runoff and collected in a container, where it evaporates. Clean the run-off channel regularly, in order to guarantee a continuous outflow of defrost water.

Before cleaning, unplug the appliance from the mains.

- Use a sponge soaked in lukewarm water and/or neutral detergent.
- Rinse and dry with a soft cloth. **Do not use abrasive materials.**

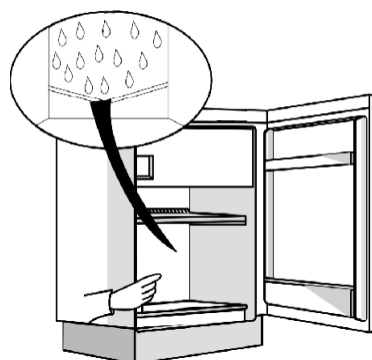

## CLEANING AND MAINTENANCE

- Clean the air vents regularly with a vacuum cleaner or a brush.
- Clean the exterior with a soft cloth.

### **Prolonged disuse**

1. Empty the refrigerator and low temperature compartments.
2. Unplug the appliance from the mains.
3. Defrost the low temperature compartment, clean and dry both compartments.
4. Leave the doors open to prevent the formation unpleasant odours.

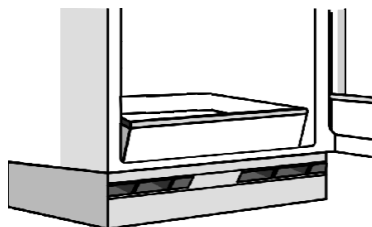

## ENERGY SAVING TIPS

- Do not expose the appliance to heat sources, direct sunlight, etc., since this will increase energy consumption.
- Do not cover the vents or air outlets.
- When thawing food items, place them in the refrigerator compartment to make use of the low temperature.
- Keep the door open as little as possible.
- Do not put food in the refrigerator when still hot.
- Do not leave the low temperature compartment door open.

## TROUBLESHOOTING GUIDE

### 1. The appliance does not work.

- Is there a power failure?
- Is the plug properly inserted in the socket?
- Is the double-pole switch on?
- Has the fuse blown?
- Is the thermostat set to **0** (Stop)?

### 2. Temperature inside the compartments is not cold enough.

- Do the doors close properly?
- Is the appliance installed near a heat source?
- Is the thermostat correctly set?
- Is air circulation inhibited?

### 3. The temperature inside the refrigerator compartment is too cold.

- Is the thermostat correctly set?

### 4. Water collects in the bottom of the refrigerator compartment.

- Is the defrost water run-off clogged?

### 5. The internal light does not work.

First refer to point 1, and then:

- Unplug the appliance from the mains power supply.
- Refer to the instructions and illustration on the enclosed sheet to access the light-bulb.
- Check the bulb and replace if necessary. (E14 type, 15W max).

### 6. Excessive formation of frost/ice in the low temperature compartment.

- Is the low temperature compartment door properly closed?

#### Notes:

- Gurgling or hissing noises inside the refrigerating circuit are quite normal.

## AFTER-SALES SERVICE

### Before contacting our After-Sales Service:

1. Try to remedy the problem (see "Troubleshooting guide").
2. Restart the appliance to see if the fault repeats. If the fault persists, switch off the appliance and switch on again after an hour.
3. If the fault still persists, contact the After-Sale Service and specify the following:
  - the nature of the problem
  - the model

- the service number (the number after SERVICE on the rating plate located on the side of the fruit and vegetable drawer)
- your full address
- your telephone number plus area code.

**SERVICE** 0000 000 00000



**Note: changes to the door opening direction carried out by our Customer Service are not covered in the terms of the guarantee.**

## INSTALLATION AND DOOR REVERSIBILITY

- Do not install the appliance near a heat source (minimum distances: 30 cm from solid fuel or gasoil stoves, 3 cm from electric ovens and hobs).
- Install the appliance in a dry and wellventilated place.
- **Do not cover the air vents.**
- Clean the appliance interior (see relevant chapters).
- Mount the accessories.

### ELECTRICAL CONNECTION

- **Electrical connections must be made in accordance with local regulations.**
- Voltage and absorption rates are indicated on the rating plate.

- **The appliance must be earthed as prescribed by law. The manufacturer declines all liability for personal injury or damage to property or animals resulting from failure to comply with the above requirements.**
- If the appliance plug and wall socket are incompatible, the socket must be replaced by a qualified electrician.
- Do not use extension leads or multiple adapters.

### ELECTRICAL DISCONNECTION

- It must be possible to disconnect the appliance from the mains by removing the plug or by disconnecting a two-pole circuit breaker.

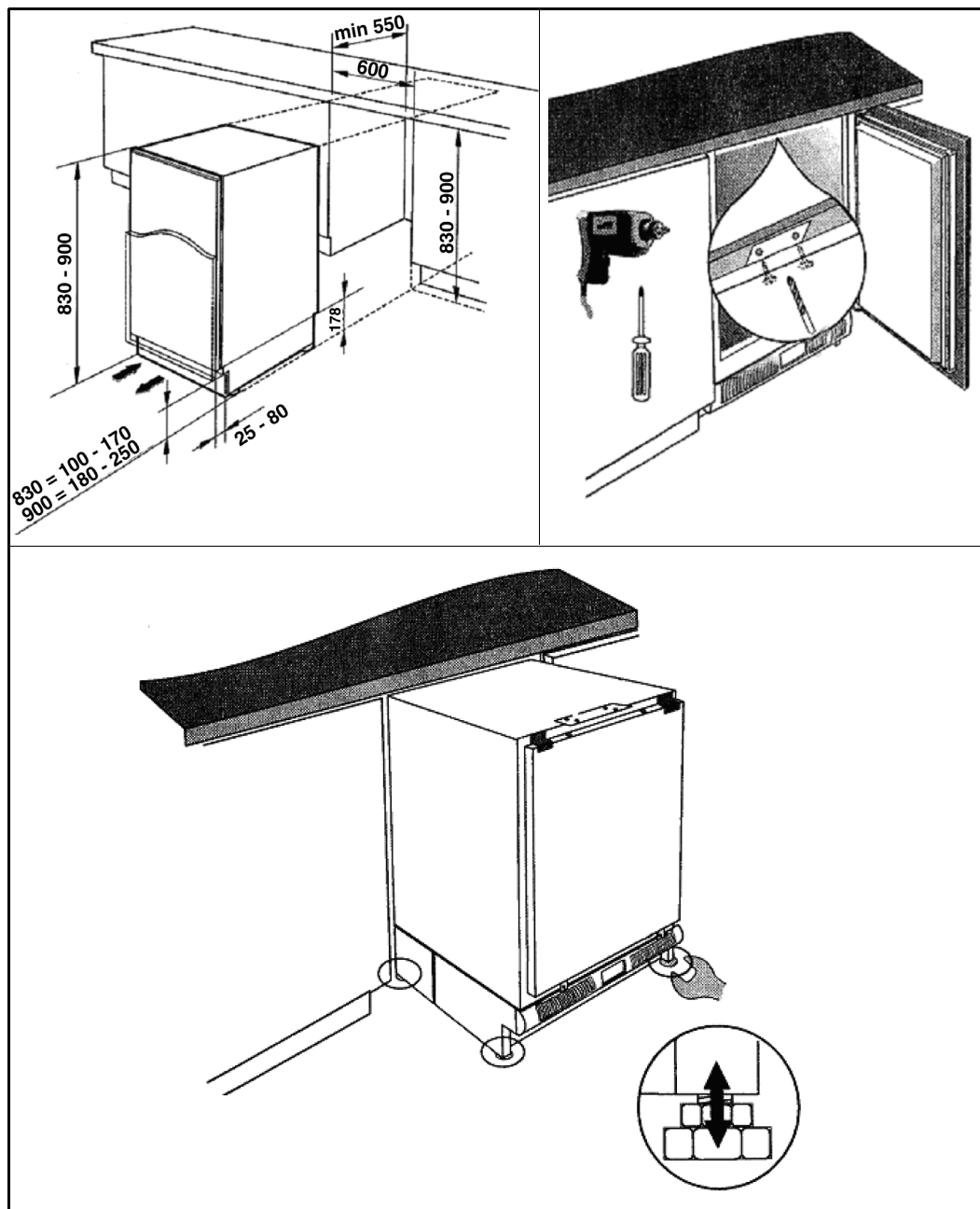



- This must be done before fitting the cabinet outer door.
- Ensure that the fridge is unplugged and empty.
- We recommend you to have someone to assist you.

#### Tools required

- Phillips style screwdriver.
- Flat bladed screwdriver.

**WARNING!** Take care when opening the hinges. They are sprung and there is a risk of injury if they close on your hand

Remove the blanking plates from the outside of the Larder fridge door.

With the door closed remove the screws on the outside of the hinges. Start with the top hinge.

Open the hinges away from the door.

Supporting the bottom of the door as you do so. Be careful with the hinges. Remove the door.

With the top hinge open undo the screws holding it to the cabinet. Be careful with the hinge, use a long shafted screwdriver if you have one.

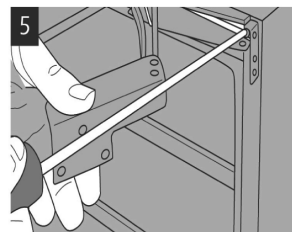
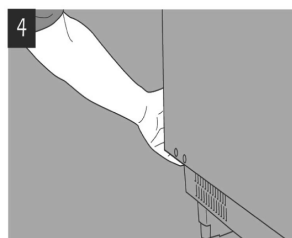
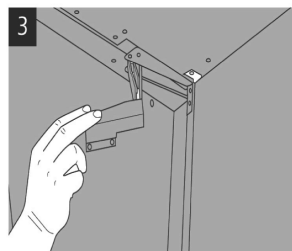
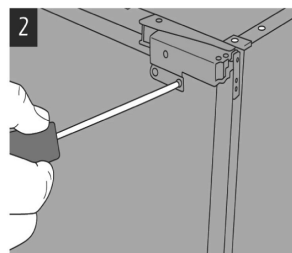
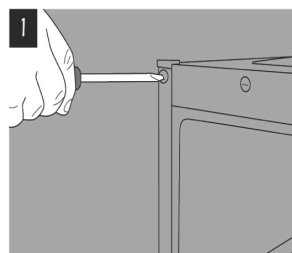

Remove the blanking plates for the cabinet.

Turn the hinge over and place it on the diagonally opposite corner of the cabinet. Screw back in place.

Repeat with the other hinge. Replace the cabinet blanking plates.

Replace the door and re-attach the hinges.

Check that the Larder fridge door is aligned horizontally and vertically and that the door seals are secure on all sides before finally tightening the hinge bracket screws.

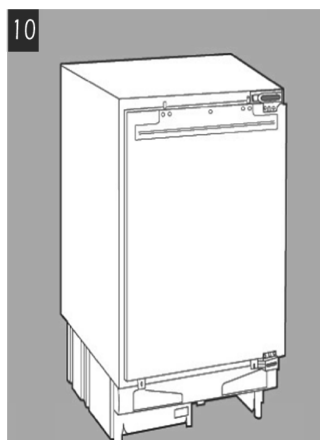
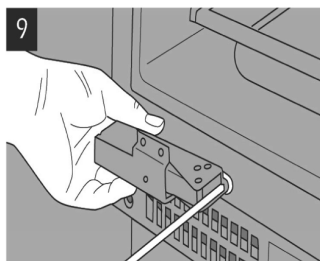
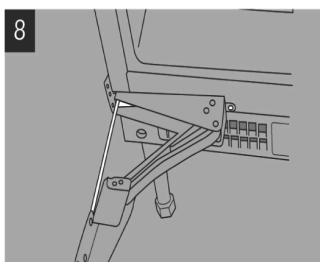
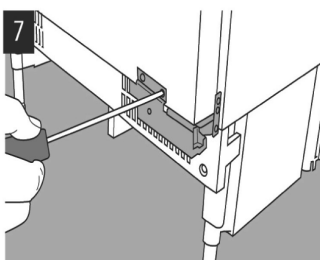
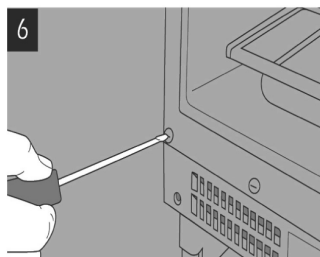

## ELECTRICAL CONNECTION

### For Great Britain only

#### Warning - this appliance must be earthed

#### Fuse replacement

If the mains lead of this appliance is fitted with a BS 1363A 13amp fused plug, to change a fuse in this type of plug use an A.S.T.A. approved fuse to BS 1362 type and proceed as follows:

1. Remove the fuse cover (A) and fuse (B).
2. Fit replacement 13A fuse into fuse cover.
3. Refit both into plug.

#### Important:

The fuse cover must be refitted when changing a fuse and if the fuse cover is lost the plug must not be used until a correct replacement is fitted.

Correct replacement are identified by the colour insert or the colour embossed in words on the base of the plug.

Replacement fuse covers are available from your local electrical store.

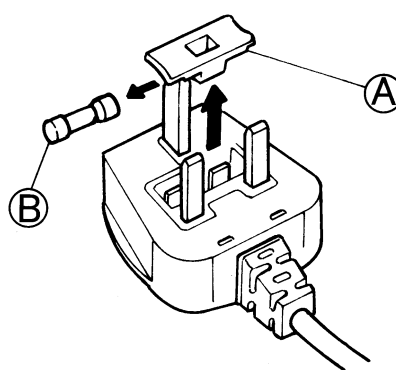

### For the Republic of Ireland only

The information given in respect of Great Britain will frequently apply, but a third type of plug and socket is also used, the 2-pin, side earth type.

#### Socket outlet / plug (valid for both countries)

If the fitted plug is not suitable for your socket outlet, Please contact Whirlpool Service for further instruction. Please do not attempt to change plug yourself. This procedure needs to be carried out by a qualified Whirlpool technician in compliance with the manufactures instructions and current standard safety regulations.