

KitchenAid

FOOD PROCESSOR

5KFP0719

OWNER'S MANUAL

EN	Owner's Manual	2
DE	Bedienungsanleitung	12
FR	Le manuel d'utilisation	23
IT	Manuale del proprietario	34
NL	Gebruikershandleiding	43
ES	El manual del propietario	53
PT	Manual do proprietário	63
EL	Εγχειρίδιο Κατοχού	73
SV	Användarhandbok	83
NO	Brukerhåndbok	92
FI	Omistajan Opas	101
DA	Brugervejledning	110
IS	Notandahandbók	119
PL	Instrukcja Obsługi	128
CS	Uživatelská Příručka	137
TR	Kullanıcı Kilavuzu	146
UA	Посібник з експлуатації	155
AR	تليل لملك	1

PRODUCT SAFETY

Your safety and the safety of others are very important.

We have provided many important safety messages in this manual and on your appliance. Always read and obey all safety messages.



This is the safety alert symbol.

This symbol alerts you to potential hazards that can kill or hurt you and others.

All safety messages will follow the safety alert symbol and either the word "DANGER" or "WARNING." These words mean:

⚠ DANGER

You can be killed or seriously injured if you don't immediately follow instructions.

⚠ WARNING

You can be killed or seriously injured if you don't follow instructions.

All safety messages will tell you what the potential hazard is, tell you how to reduce the chance of injury, and tell you what can happen if the instructions are not followed.

IMPORTANT SAFEGUARDS

When using electrical appliances, basic safety precautions should always be followed, including the following:

1. Read all instructions. Misuse of appliance may result in personal injury.
2. To protect against risk of electrical shock, do not put Food Processor in water or other liquid.
3. Unplug from the outlet when not in use, before putting on or taking off parts, and before cleaning.
4. European Union Only: This appliance shall not be used by children. Keep the appliance and its cord out of reach of children.
5. European Union Only: Appliances can be used by persons with reduced physical, sensory, or mental capabilities or lack of experience and knowledge if they have been given supervision or instruction concerning use of the appliance in a safe way and understand the hazards involved.

6. This appliance is not intended for use by persons (including children) with reduced physical, sensory, or mental capabilities, or lack of experience or knowledge, unless they have been given supervision or instruction concerning use of the appliance by a person responsible for their safety.
7. Children should be supervised to ensure they do not play with the appliance.
8. Avoid contacting moving parts.
9. Do not operate any appliance with a damaged cord or plug, or after the appliance malfunctions, or is dropped or damaged in any manner. Return appliance to the nearest Authorised Service Facility for examination, repair, or electrical or mechanical adjustment.
10. If the supply cord is damaged, it must be replaced by KitchenAid, its service agent or similarly qualified persons in order to avoid a hazard.
11. Turn the appliance off (O/Pulse), then unplug from the outlet when not in use, before assembling or disassembling parts and before cleaning. To unplug, grasp the plug and pull from the outlet. Never pull from the Power Cord.
12. The use of accessories/attachments not recommended or sold by KitchenAid may cause fire, electric shock, or injury.
13. Do not use the appliance outdoors.
14. Do not let cord hang over edge of table or counter.
15. Be careful if hot liquid is poured into the Food Processor as it can be ejected out of the appliance due to sudden steaming.
16. Never leave the appliance unattended while it is in operation.
17. Keep hands and utensils away from moving blades or discs while processing food to reduce the risk of severe injury to persons or damage to the Food Processor. A scraper may be used, but must be used only when the Food Processor is not running.
18. Blades are sharp. Care should be taken when handling the sharp cutting blades, emptying the jar, and during cleaning.
19. To reduce the risk of injury, never place cutting blade or discs on base without first putting Bowl properly in place.
20. Be certain cover is securely locked in place before operating appliance.
21. Never feed food by hand. Always use the food pusher.
22. Do not attempt to defeat the cover interlock mechanism.

23. Do not fill the Bowl above the marked maximum fill line (or rated capacity) to avoid risk of injury due to damage to the cover or Bowl.
24. Allow the appliance to cool completely before putting on or taking off parts, and before cleaning the appliance.
25. Refer to the “Care and Cleaning” section for instructions on cleaning the surfaces in contact with food.
26. This appliance is intended to be used in household and similar applications such as:
 - staff kitchen areas in shops, offices and other working environments;
 - farmhouses;
 - by clients in hotels, motels and other residential type environments;
 - bed and breakfast type environments.

SAVE THESE INSTRUCTIONS

For complete details on product information, instructions and videos, including Guarantee information, visit www.KitchenAid.co.uk or www.KitchenAid.eu. This may save you the cost of a service call. To receive a free printed copy of the information online, call **00 800 381 040 26**.

ELECTRICAL REQUIREMENTS

Voltage: 220-240 V~

Frequency: 50-60 Hz

NOTE: If the plug does not fit in the outlet, contact a qualified electrician. Do not modify the plug in any way.

ACCESSORIES SELECTION GUIDE

ACTION	SETTING	FOOD	ACCESSORY
Chop	1 or O/Pulse	Cheese, Chocolate, Fruits, Fresh herbs, Nuts, Tofu, Vegetables	Multipurpose Stainless Steel Blade
Mince or Purée	2 or O/Pulse		
Mix	1	Pasta Sauce, Pesto, Salsa, Sauces, Batters	

ACTION	SETTING	FOOD	ACCESSORY
Slice	1	Fruit (soft), Potatoes, Tomatoes, Vegetables (soft)	Reversible Slicing/ Shredding Disc (slicing side) OR Slicing Blade
	2	Cheese, Chocolate, Fruits (hard), Vegetables (hard)	
Shred (fine to medium)	1	Potatoes, Vegetables (soft)	Reversible Slicing/ Shredding Disc (shredding side)
	2	Cabbage, Cheese, Chocolate, Fruits (hard), Vegetables (hard)	
Knead	O/Pulse or 2	Yeast doughs	Dough blade

PRODUCT USAGE

BEFORE FIRST USE

Before using your Food Processor for the first time, wash all parts and accessories either by hand or in the dishwasher (see the “Cleaning the Food Processor” section). Your Food Processor is designed so that all accessories may be stored inside the work bowl.

1. Lift up the Lid Latch to unlock the cover. Tilt the Work Bowl cover back and lift it straight up so that the Lid Hinge pulls out of the Handle Hinge.
2. Remove all parts and accessories from the Work Bowl, and lift the Food Pusher out of the feed tube.

ASSEMBLING THE FOOD PROCESSOR

IMPORTANT: Place the Food Processor on a dry, level countertop with the controls facing forward. Do not plug in the Food Processor until it is completely assembled.

1. Place the Work Bowl on the base, aligning the handle with the raised button on the right side of the base. The bowl will click into place and should be flush against the base when properly aligned.
2. Place the Drive Adapter in the Work Bowl, lowering it onto the Drive Pin.
NOTE: For ease of assembly, install the desired blade or disc before attaching the Work Bowl cover.
3. To attach the Work Bowl cover, push the Lid Hinge into the Handle Hinge on the Work Bowl and close the cover.
4. Once the Work Bowl cover is closed, push the Lid Hinge down into the locked position.
NOTE: Your Food Processor will not operate unless the Work Bowl cover is fully closed and the Work Bowl is properly seated on the base.

INSTALLING THE MULTIPURPOSE BLADE OR DOUGH BLADE

1. Place the Blade on the Drive Adapter. Rotate the blade so it falls down to the Base of the Adapter.

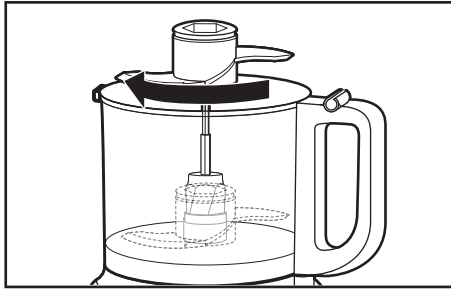

2. Install the Work Bowl cover, making sure the Lid Latch is pushed down to the locked position.

The Dough Blade is designed for mixing and kneading yeast dough quickly and thoroughly. For the best results, use O/Pulse to mix the dry ingredients and then speed 2 when adding water.

The maximum recommended capacity for dough ingredients: flour 375 g (3 cups), 260 g/ ml of water.

INSTALLING THE REVERSIBLE SLICING/SHREDDING DISC OR SLICING BLADE

1. **To slice:** Turn the disc so that the raised Slicing Blade is facing up.
To shred: Turn the disc so that the small, raised Shredding Blades are facing up.

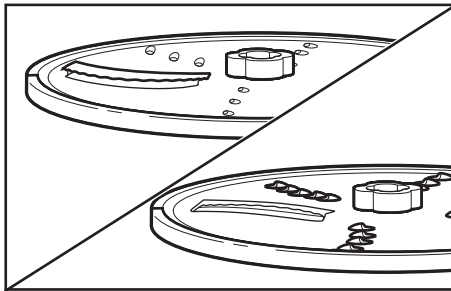

The disc can be placed in two different positions: high at the top of the bowl for processing, and low in the bowl for storage.

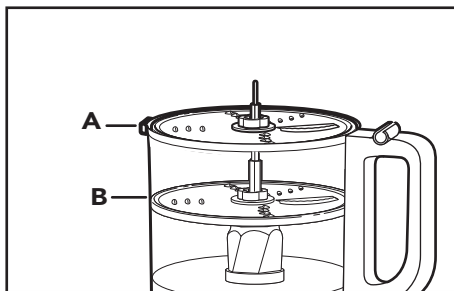

A. Process

B. Storage

NOTE: While the disc will operate in storage position, it will not perform as well. Make sure the disc is level with the top of the bowl for best performance.

2. Hold the disc by its centre hub and lower it onto the Drive Adapter, aligning the marks on the centre hub of the disc to the marks on the adapter. The disc should be level with the top of the bowl. If the disc falls to the storage position, lift it out, turn it 90°, and lower it again.

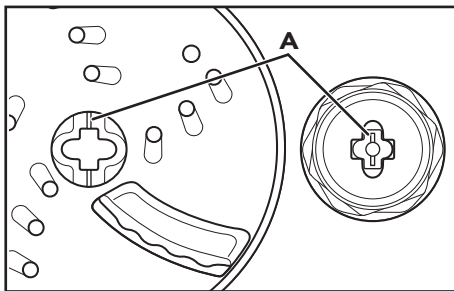

A. Alignment marks

3. Install the Work Bowl cover, making sure the Lid Latch is pushed down to the locked position.

OPERATING THE FOOD PROCESSOR

Before operating the Food Processor, be sure the Work Bowl, Blades, and Work Bowl Cover are properly assembled on the base (see the “Assembling the Food Processor” section).

⚠ WARNING

Rotating Blade Hazard



Always use food pusher.

Keep fingers out of openings.

Keep away from children.

Failure to do so can result in amputation or cuts.

1. To turn on, press 1 or 2. The Food Processor will run continuously and the indicator light will glow. To turn off, press 1 or 2 again, or press O/Pulse.

2. **To use the Pulse function:** Press O/Pulse for short bursts, or press and hold for longer bursts. The Pulse function runs at high speed only. The Food Processor will turn off when the O/Pulse button is released.
3. When finished, press O/Pulse. The indicator light will go out and the blade or disc will slow to a stop.
4. Wait until the Blade or Disc comes to a complete stop before removing the Work Bowl Cover. Be sure to turn off the Food Processor before removing the Work Bowl Cover, or before unplugging the Food Processor.

USING THE 2-IN-1 FEED TUBE

The 2-in-1 Feed Tube features a 2-Piece Food Pusher. To slice or shred small items, insert the 2-Piece Food Pusher into the feed tube.

Use the small feed tube and pusher to process small or slender items, like single carrots or celery stalks.

To slowly drizzle oil into ingredients, just fill the small pusher with the desired amount of oil. A small hole in the bottom of the pusher will drizzle the oil at a constant rate.

REMOVING PROCESSED FOODS

1. Turn the Food Processor off: Press the O/Pulse button and unplug the Food Processor before disassembling.
2. Lift the Lid Latch to unlock the Work Bowl Cover, then lift cover to remove.
3. If using a Disc, remove it before removing the Bowl. Holding the Disc by the centre hub, lift it straight up.
4. Remove the Drive Adapter, then the Multipurpose Blade or Dough Blade, if using. The blade will stay in place on the Drive Adapter when you remove the Adapter.
5. Lift the Work Bowl off of the base to remove food from the bowl with a spatula.

CARE AND CLEANING

CLEANING THE FOOD PROCESSOR

IMPORTANT: Allow the appliance to cool completely before putting on or taking off parts, and before cleaning the appliance. The BPA-free bowl requires special handling. If you choose to use a dishwasher instead of hand washing, please follow these guidelines.

1. Press O/Pulse, then unplug the Food Processor before cleaning.
2. Wipe the base and cord with a warm, damp cloth. Thoroughly dry with a soft cloth. Do not use abrasive cleaners or scouring pads. Do not immerse base in water or other liquid.
3. All parts are top rack dishwasher-safe. Avoid laying the bowl on its side. Thoroughly dry all parts after washing. Use gentle dishwashing cycles such as normal. Avoid high-temperature cycles.

NOTE: If washing the food processor parts by hand, avoid the use of abrasive cleansers or scouring pads. They may scratch or cloud the Work Bowl and Cover.

4. You can store the Multipurpose Blade, Dough Blade, and both discs as well as the Drive Adapter inside of the Work Bowl when the Food Processor is not in use. Wrap the Power Cord around the cord storage on the bottom of the base, then secure the plug by clipping it to the housing.

ELECTRICAL EQUIPMENT WASTE DISPOSAL

DISPOSAL OF PACKING MATERIAL

The packing material is recyclable and is marked with the recycle symbol . The various parts of the packing must therefore be disposed of responsibly and in full compliance with local authority regulations governing waste disposal.

RECYCLING THE PRODUCT

- This appliance is marked in compliance with law in the EU and UK covering, Waste Electrical and Electronic Equipment (WEEE).
- By ensuring this product is disposed of correctly, you will help prevent potential negative consequences for the environment and human health, which could otherwise be caused by inappropriate waste handling of this product.
- The symbol  on the product or on the accompanying documentation indicates that it should not be treated as domestic waste but must be taken to an appropriate collection centre for the recycling of electrical and electronic equipment.

For more detailed information about treatment, recovery and recycling of this product, please contact your local city office, your household waste disposal service or the shop where you purchased the product.

DECLARATION OF CONFORMITY

FOR UNITED KINGDOM

This appliance has been designed, constructed and distributed in compliance with the safety requirements of UK Legislation: Electrical Equipment (Safety) Regulations 2016, Electromagnetic Compatibility Regulations 2016. The Ecodesign for Energy-Related Products and Energy Information (Amendment) (EU Exit) Regulations 2019. The Restriction of the Use of Certain Hazardous Substances in Electrical and Electronic Equipment Regulations 2012.

FOR EUROPEAN UNION

This appliance has been designed, constructed, and distributed in compliance with the safety requirements of EC Directives: Low Voltage Directive 2014/35/EU, Electromagnetic Compatibility Directive 2014/30/EU, Ecodesign Directive 2009/125/EC, RoHS Directive 2011/65/EU and following amendments.

TERMS OF KITCHENAID GUARANTEE ("GUARANTEE")

Covering U.K. - Ireland - South Africa - UAE

KitchenAid Europa, Inc., Nijverheidslaan 3, Box 5, 1853 Strombeek-Bever, Belgium ("Guarantor") grants the end-customer, who is a consumer, a Guarantee pursuant to the following terms.

FOR U.K.:

The Guarantee applies in addition to and does not limit or affect the statutory warranty rights of the end-customer against the seller of the product. In summary, the Consumer Rights Act 2015 says products must be as described, fit for purpose and of satisfactory quality. During the expected lifespan of your product your legal rights entitle you to the following:

- Up to 30 days: if your product is faulty, then you can get an immediate refund.
- Up to six months: if your product can't be repaired or replaced, then you're entitled to a full refund, in most cases.
- Up to six years: if your product does not last a reasonable length of time you may be entitled to some money back.

These rights are subject to certain exceptions. For detailed information please visit the Citizens Advice website www.adviceguide.org.uk or call **03454 04 05 06**.

FOR IRELAND:

The Guarantee applies in addition to and does not limit or affect the statutory warranty rights of the end-customer against the seller of the product under the European Communities (Certain Aspects of the Sale of Consumer Goods and Associated Guarantees Regulations 2003 (S.I. No. 11/2003)) and other enactments governing the sale of consumer goods.

FOR SOUTH AFRICA:

The Guarantee applies in addition to and does not limit or affect the statutory warranty rights of the end-customer against the seller of the product. In summary, the Consumer Protection Act, 2008 says that products must be: (i) reasonably suitable for the purpose for which they are intended; (ii) in good working order, of good quality and free of any defects; (iii) useable and durable for a reasonable period of time, having regard to the use to which they would normally be put and to all the surrounding circumstances; and (iv) in compliance with any applicable standards or any other public regulations.

During the expected lifespan of your product and where the products are not purchased online, your legal rights will entitle you to the following:

- You will be entitled to a full refund, if you did not have the opportunity to examine the product before delivery and if you rejected delivery of the product on the basis that the type and quality of the product was not as reasonably expected or did not reasonably conform to the material specifications.
- Within 5 business days after delivery: you may rescind your purchase and request a refund, if your purchase resulted from direct marketing.
- Within 10 business days after delivery: you will be entitled to a full refund, if it is found that the product was unsuitable for a particular purpose specifically communicated to you by the Guarantor.
- Within 15 business days after delivery: you will be entitled to a refund if: (i) the product was not delivered to you; or (ii) if you returned the product to the Guarantor.
- Within 6 months after delivery: you will be entitled to a refund or a replacement product, if the product is defective or fails to operate in terms of its specifications.

Where you have purchased a product online your legal rights will be governed by the Electronic Communications and Transactions Act, 2002 and you will be entitled to the following:

- Within 7 days after conclusion of the transaction or after delivery: you may cancel your purchase without reason and without penalty.
- Within 30 days of the date of cancellation of the transaction: you will be entitled to receive a refund, if you have already made payment.
- You will only be liable for the direct costs of returning the product to the Guarantor.

FOR UAE:

The Guarantee applies in addition to and does not limit or affect the statutory warranty rights of the end-customer against the seller of the product.

1. SCOPE AND TERMS OF THE GUARANTEE

- a) The Guarantor grants the Guarantee for the products mentioned under Section 1.b) which a consumer has purchased from a seller or a company of the KitchenAid-Group within the following countries: U.K., Ireland, or South Africa, or the United Arab Emirates (UAE).
- b) The Guarantee period depends on the purchased product and is as follows:
Two Year full guarantee from date of purchase.
- c) The Guarantee period commences on the date of purchase, i.e. the date on which a consumer purchased the product from a dealer or a company of the KitchenAid-Group.
- d) The Guarantee covers the defect-free nature of the product.
- e) The Guarantor shall provide the consumer with the following services under this Guarantee, at the choice of the Guarantor, if a defect occurs during the Guarantee period:
 - Repair of the defective product or product part, or
 - Replacement of the defective product or product part. If a product is no longer available, the Guarantor is entitled to exchange the product for a product of equal or higher value.

- f) If the consumer wishes to make a claim under the Guarantee, the consumer has to contact the country specific KitchenAid service centres or the Guarantor directly at KitchenAid Europa, Inc. Nijverheidslaan 3, Box 5, 1853 Strombeek-Bever, Belgium;

Email-Address U.K.: CONSUMERCARE.UK@kitchenaid.eu

Email-Address IRELAND: CONSUMERCARE.IE@kitchenaid.eu

Toll Free Number U.K. & IRELAND: **00 800 381 040 26**

FOR SOUTH-AFRICA:

Our local KitchenAid Distributor:

KitchenAid Africa
PO Box 52102
V&A Waterfront
Cape Town
8002

Contact our distributor:

Telephone: +27 21 555 0700

You can contact our Customer Service Centre for Small Domestic Appliances from 8.30 am to 1.00 pm and from 1.30 pm to 5.00 pm or write to us at the following address: hello@kitchenaidafrica.com

FOR UAE:

AL GHANDI ELECTRONICS.

POST BOX NO. 9098,
DUBAI, UNITED ARAB EMIRATES
Toll free number: +971 4 2570007

- g) The costs of repair, including spare parts, and any postage costs (if applicable) for the delivery of a defect-free product or product part shall be borne by the Guarantor. The Guarantor shall also bear the postage costs for returning the defective product or product part if the Guarantor or the country specific KitchenAid customer service centre requested the return of the defective product or product part. However, the consumer shall bear the costs of appropriate packaging for the return of the defective product or product part.
- h) To be able to make a claim under the Guarantee, the consumer must present the receipt or invoice of the purchase of the product.

2. LIMITATIONS OF THE GUARANTEE

- a) The Guarantee applies only to products used for private purposes and not for professional or commercial purposes.
- b) The Guarantee does not apply in the case of normal wear and tear, improper or abusive use, failure to follow the instructions for use, use of the product at the wrong electrical voltage, installation and operation in violation of the applicable electrical regulations, and use of force (e.g. blows).
- c) The Guarantee does not apply if the product has been modified or converted, e.g. conversions from 120 V products to 220-240 V products.
- d) The provision of Guarantee services does not extend the Guarantee period, nor does it initiate the commencement of a new Guarantee period. The Guarantee period for installed spare parts ends with the Guarantee period for the entire product.
- e) **FOR SOUTH-AFRICA & UAE ONLY:**

Further or other claims, in particular claims for damages, are excluded unless liability is mandatory by law.

After expiry of the Guarantee period or for products for which the Guarantee does not apply, the KitchenAid customer service centres are still available to the end-customer for questions and information.

Further information is also available on our website:

- For U.K. & Ireland www.kitchenaid.eu
- For South-Africa: www.kitchenaidafrica.com
- For UAE: www.KitchenAid-MEA.com

PRODUCT REGISTRATION

Register your new KitchenAid appliance now: <http://www.kitchenaid.eu/register>



KitchenAid

©2023 All rights reserved.